



American  
Brachytherapy  
Society

# American Brachytherapy Society 2009 Annual Meeting **Final Program**

May 31 - June 2, 2009 | Westin Harbour Castle | Toronto, Ontario, Canada



## 2009 Annual Meeting Learning Objectives:

At the conclusion of this educational activity, the participant should be able to:

1. Describe refresher courses in prostate, breast, and gynecologic brachytherapy with a focus on improving the therapeutic ratio
2. Evaluate clinical updates from leading world experts in the field of brachytherapy
3. Compare innovative methods of prostate and breast brachytherapy with interactive workshops
4. Compare treatment options for high-risk prostate cancer
5. Review focal, targeted therapies for early stage prostate and breast cancers
6. Debate the various methods of partial breast irradiation for treatment of early stage disease
7. Demonstrate brachytherapy techniques in less common disease sites with an interactive video-based show and tell session
8. Explain the latest research in brachytherapy physics
9. Review advances in imaging and current brachytherapy techniques
10. Address current topics in brachytherapy-specific treatment planning systems and quality assurance measures
11. Explore the role of advanced technology and physics in the development of future brachytherapy approaches
12. Discuss the role of heterogeneity corrections in brachytherapy systems
13. Highlight current controversies in hypofractionated external beam radiation versus brachytherapy

### American Brachytherapy Society 2009 Annual Meeting Preliminary Program

May 31 - June 2, 2009  
Westin Harbour Castle  
Toronto, Ontario, Canada

#### Conflict of Interest and Off-Label Disclosure Statement

Presenters at this conference will disclose any conflict of interest or their intention to discuss off-label use, if applicable, in accordance with ACCME Standards and FDA requirements. Conflicts will be disclosed in print in the final meeting materials.

#### Accreditation and Credit Statement

This activity has been planned and implemented in accordance with the Essential Areas and policies of the Accreditation Council for Continuing Medical Education (ACCME) through the joint sponsorship of Virginia Commonwealth University (VCU) School of Medicine and American Brachytherapy Society. VCU is accredited by the ACCME to provide continuing medical education for physicians.

Physicians may claim up to 21 hours in Type 1 or Type 2 CME on the Virginia Board of Medicine Continued Competency and Assessment Form required for renewal of an active medical license.

VCU designates this educational activity for a maximum of 21 *AMA PRA Category 1 Credits*<sup>™</sup>. Physicians should only claim credit commensurate with the extent of their participation in the activity.

This continuing education activity meets the criteria of Virginia Commonwealth University and the Southern Association of Colleges and Schools. 2.1 CEUs will be awarded and recorded with the University.



## 2009 Annual Meeting Scientific Program Committee

**Rakesh Patel, MD**  
 Scientific Program Chair  
 Western Radiation Oncology  
 Mountain View, CA

**Keith Furutani, PhD**  
 Mayo Clinic  
 Rochester, MN

**Gerard Morton, MD**  
 Sunnybrook Regional Cancer Center  
 Toronto, Ontario, Canada

**Thomas Shanahan, MD**  
 University Radiologists  
 Springfield, IL

**Akila Viswanathan, MD, MPH**  
 Harvard Medical School  
 Brigham and Women's Hospital /  
 Dana Farber Cancer Institute  
 Boston, MA

## Acknowledgment of 2009 Annual Meeting Commercial Support

The American Brachytherapy Society would like to acknowledge the special support, through an unrestricted educational grant, of the following organizations, who contribute not only to the Annual Meeting but to other ABS programs and events throughout the year:

**Best Medial International**

**Nucletron**

**Oncura**

**Theragenics Corporation**

**Varian BrachyTherapy**

## ABS Monday Night Gala Event at The Hart House

The Gala Event Monday night is for paid attendees and paid guests. Exhibitors must register at the ABS registration desk at \$125 per person. Enjoy, light food, drinks and music while networking and talking with fellow attendees and guests. Dress is business casual and attendees should meet in the hotel lobby between 6:00 and 6:15 for bus transportation to the event. Return transportation is also provided, however attendees are free to see surrounding sites, restaurants, etc. at the conclusion of the Gala Event and return later to the hotel via taxicab.

## ABS Past Presidents

2009 Brian J. Davis, MD, PhD

2008 Gregory S. Merrick, MD

2007 W. Robert Lee, MD

2006 Douglas W. Arthur, MD

2005 Frank A. Vicini, MD

2004 Michael J. Zelefsky, MD

2003 Beth A. Erickson, MD

2002 Colin Orton, PhD

2001 David Beyer, MD

2000 James Fontanesi, MD

1999 Subir Nag, MD

1998 Kent Wallner, MD

1996-97 Burton L. Speiser, MD

1995 Arthur T. Porter, MD

1994 John C. Blasko, MD

1993 Louis B. Harrison, MD

1992 Alvaro A. Martinez, MD

1991 Kenneth H. Luk, MD

1990 Peter A. Fleming, MD

1989 Dattatreyudu Nori, MD

1988 Karen K. Fu, MD

1987 Luis Delclos, MD

1986 Basil S. Hilaris, MD

1985 Don R. Goffinet, MD

1984 A.M. Nisar Syed, MD

1983 Thomas C. Gates, MD

1982 Ajmel A. Puthawala, MD

1981 Paul Y. M. Chan, MD

1980 Aaron G. Fingerhut, MD

1979 David L. Neblett, MS

1978 Harvey S. Frey, MD, PhD

# Annual Meeting Faculty

**Douglas Arthur, MD**  
Professor and Vice Chairman  
VCU Medical Center/Massey  
Cancer Center  
Richmond, VA

**Mostafa Atri, MD**  
University of Toronto  
Toronto, Ontario, Canada

**Luc Beaulieu, PhD**  
Associate Professor and Head of  
Physics Research  
Centre Hospitalier de Quebec  
Quebec, PQ, Canada

**Peter D. Beitsch, MD, FACS**  
Dallas Surgical Group  
Dallas, TX

**Sushil Beriwal, MD**  
Residency Program Director &  
Medical Director  
Magee Women's Hospital  
Pittsburgh, PA

**Ashwini Budrukhar, MD**  
Assistant Professor  
Tata Memorial Hospital  
Mumbai, India

**Wayne Butler, PhD**  
Medical Physicist  
Schiffler Cancer Center/Wheeling  
Jesuit University  
Wheeling, WV

**Asa Carlesson, MD**  
Research Fellow  
Linköping University  
Linköping, Sweden

**Jamie Cesarreti, MD**  
Florida Radiation Oncology Group  
Jacksonville, FL

**Joe Chin, MD**  
Chair, Division of Surgical  
Oncology  
University of Western Ontario  
Ontario, Canada

**Gilad Cohen, MS**  
Memorial Sloan-Kettering Cancer  
Center  
New York, NY

**Juanita Crook, MD**  
Professor of Radiation Oncology  
Princess Margaret Hospital  
Toronto, Ontario, Canada

**Laurie Cuttino, MD**  
Assistant Professor  
Virginia Commonwealth University,  
Medical College Of Virginia  
Richmond, VA

**Brian Davis, MD**  
Mayo Clinic  
Rochester, MN

**Phillip Devlin, MD**  
Director of Brachytherapy  
Harvard Medical School  
Boston, MA

**Adam Dickler, MD**  
Little Company of Mary  
Evergreen Park, IL

**David D'Souza, MD**  
Radiation Oncologist  
London Health Sciences Center  
London, Ontario, Canada

**Patricia Eifel, MD**  
Professor of Radiation Oncology  
MD Anderson Cancer Center  
Houston, TX

**Michael Evans, MD**  
Montreal General Hospital  
Montreal, QC, Canada

**Don Fuller, MD**  
Radiation Medical Group  
San Diego, CA

**Keith Furutani, PhD**  
Assistant Professor  
Mayo Clinic  
Rochester, MN

**David Jaffney, PhD**  
Ontario Cancer Institute  
Toronto, Ontario, Canada

**Gary Gustafson, MD**  
William Beaumont Hospital  
Troy, MI

**Masoon Haider, MD**  
University of Toronto  
Toronto, Ontario, Canada

**Jorgen Hansen, PhD**  
Chief of Brachytherapy Physics  
Brigham and Women's Hospital  
Boston, MA

**John Hayes MD, MS**  
Gamma West Brachytherapy  
Salt Lake City, UT

**Caroline Holloway, MD**  
BC Cancer Agency, Vancouver Island Cancer  
Center  
Vancouver, BC, Canada

**Eric Horwitz, MD**  
Chairman  
Fox Chase Cancer Center  
Philadelphia, PA

**I-Chow "Joe" Hsu, MD**  
Associate Professor of Radiation Oncology  
University of California at San Francisco  
San Francisco, CA

**Kennith Hu, MD**  
Assistant Professor  
Memorial Sloan-Kettering Cancer Center  
New York, NY

**Martin E. Keisch, MD**  
Cedars Medical Center  
Miami, FL

**Mira Keyes, MD, FRCPC**  
Head, Provincial Prostate Brachytherapy  
Program  
BC Cancer Agency  
Vancouver, BC, Canada

**Deepak Khuntia, MD**  
Assistant Professor  
University Of Wisconsin  
Madison, WI

**Adam Kibel, MD**  
Washington University School of medicine  
St. Louis, MO

**Christian Kirisits, PhD, ScD**  
Associate Professor  
Medical University of Vienna  
Vienna, Austria

**Steve Kurtzman, MD**  
Director of Prostate Brachytherapy  
Western Radiation Oncology  
San Mateo, CA

**Robert R. Kuske, Jr., MD**  
Arizona Breast Cancer Services  
Scottsdale, AZ

**W. Robert Lee, MD**  
Professor, Department of  
Radiation Oncology  
Duke University School of Medicine  
Durham, NC

**Cynthia Menard, MD**  
Princess Margaret Hospital  
Toronto, Ontario, Canada

**Gregory Merrick, MD**  
Director/Urologic Research Institute  
Schiffler Cancer Center  
Wheeling Jesuit University  
Wheeling, WV

**Michael Milosevic, MD**  
Clinician Scientist and  
Radiation Oncologist  
Princess Margaret Hospital  
Toronto, Ontario, Canada

**Gerald Morton, MD**  
Sunnybrook Regional Cancer Center  
Toronto, Ontario, Canada

**Firas Mourtada, PhD**  
Assistant Professor, Radiation Physics  
Department  
MD Anderson Cancer Center  
Houston, TX

**Subhakar Mutyala, MD**  
Montefiore Medical Center  
New York, NY

**Vrinda Narayana, PhD**  
Associate Professor, Chief Physicist  
Providence Cancer Institute  
Southfield, MI

**Rakesh Patel, MD**  
Director Of Breast Cancer Services  
Western Radiation Oncology, Inc  
Mountain View, CA

**Jean-Phillippe Pignol, MD, PhD**  
Sunnybrook Health Sciences Centre  
Toronto, Ontario, Canada

**Jean Pouliot, PhD**  
Professor and Vice Chair  
UCSF Comprehensive Cancer Center  
San Francisco, CA

**Bradley Prestidge, MD**  
Medical Director  
Texas Cancer Clinic  
San Antonio, TX

**Mark Rivard, PhD**  
Professor and Chief Medical Physicist  
Tufts-New England Medical Center  
Boston, MA

**Jason Rownd, MS**  
Senior Medical Physicist  
Medical College Of Wisconsin  
Milwaukee, WI

**Raxa Sankreacha, PhD**  
Medical Physicist  
Carlo Fidani Peel Regional Cancer Centre/  
Credit Valley Hospital  
Mississauga, Ontario, Canada

**Thomas Shanahan, MD**  
University Radiologists  
Springfield, IL

**Anil Sharma, PhD, DRP**  
Long Beach Memorial Medical Center  
Long Beach, CA

**Frank-Andre Siebert, PhD**  
Chief Medical Physicist  
UKSH Campus Kiel  
Kiel, Germany

**Ron Sloboda, PhD**  
Senior Medical Physicist  
Cross Cancer Institute  
Edmonton, Alberta, Canada

**Ingrid Spadinger, PhD**  
BC Cancer Research  
Vancouver, BC, Canada

**Nelson Stone, MD**  
Professor of Urology and  
Radiation Oncology  
Mount Sinai School of Medicine  
New York, NY

**Alphons Taghian, MD**  
Harvard Medical School  
Boston, MA

**Bruce Thomadsen, PhD**  
University Of Wisconsin  
Madison, WI

**Dorin Todor, PhD**  
Assistant Professor  
Virginia Commonwealth University  
Richmond, VA

**Jack Venselaar, PhD**  
Medical Physicist  
Dr. B. Verbeeten Institute  
Tilburg, Netherlands

**Frank Vicini, MD**  
William Beaumont Hospital  
Royal Oak, MI

**Eric Vigneault, MD, MsC**  
CHUQ, Hotel-Dieu De Quebec  
Quebec, PQ Canada

**Akila Viswanathan, MD, MPH**  
Assistant Professor of Radiation  
Oncology  
Harvard Medical School  
Chief, Gynecologic Radiation Oncology  
Brigham and Women's Hospital /  
Dana-Farber Cancer Institute  
Boston, MA

**Te Vuong, MD**  
Research Institute of the McGill  
University Health Center  
Montreal, QC, Canada

**Kent Wallner, MD**  
Department of Veterans Affairs  
Puget Sound Health Care System  
Seattle, WA

**David Wazer, MD**  
Professor and Chairman  
Department of Radiation Oncology,  
Tufts University School of Medicine  
Boston, MA

**Josh Yamada, MD**  
Assistant Attending  
Memorial Sloan-Kettering  
Cancer Center  
New York, NY

**Catheryn Yashar, MD**  
The University Of California,  
San Diego  
San Diego, CA

**Ivan Yeung, PhD**  
Princess Margaret Hospital  
Toronto, Ontario, Canada

**Marco Zaider, PhD**  
Memorial Sloan-Kettering  
Cancer Center  
New York, NY

**Michael J. Zelefsky, MD**  
Memorial Sloan-Kettering  
Cancer Center  
New York, NY



# Agenda

## Saturday, May 30

1:00 – 6:00 pm

**Registration and Commercial Exhibit Set-Up**

## Sunday, May 31

7:00 am – 4:30 pm

**Commercial Exhibits**

7:00 am – 5:00 pm

**Registration**

7:00 – 7:30 am

**Continental Breakfast**

7:30 – 7:35am

**Welcome: Rakesh Patel, MD, Scientific Program Chair**

7:35 – 8:30 am

**Prostate Brachytherapy: Improving the Therapeutic Ratio**  
**Co-Moderators:**

Mira Keyes, MD

British Columbia Cancer Agency, Vancouver, BC, Canada

Gerard Morton, MD

Toronto-Sunnybrook Regional Cancer Center, Toronto,  
Ont., Canada

8:30 – 10:10 am

**High-Risk Prostate Cancer (Audience Response System)**

**Moderator:**

Michael J. Zelefsky, MD

Memorial Sloan-Kettering Cancer Center, New York, NY

**Panelists:**

**Pro: Radical Prostatectomy**

Adam S. Kibel, MD

Washington University School of Medicine, St. Louis, MO

**Pro: Brachytherapy +/- EBRT**

Gregory S. Merrick, MD

Schiffler Cancer Center, Wheeling Jesuit University, Wheeling, WV

**Pro: IMRT Alone +/- AA**

Eric Horwitz, MD

Fox Chase Cancer Center, Philadelphia, PA

10:10 – 10:30 am

**Refreshment Break**

10:30 – 11:30 am

**Prostate Proffered Papers I**

**Co-Moderators:**

Juanita M. Crook, MD, FRCPC

Princess Margaret Hospital, Toronto, Ont., Canada

John Hayes, MS, MD

Gamma West Brachytherapy, Salt Lake City, UT

10:30 – 11:30 am  
(Parallel Session)

**Breast Proffered Papers I**

**Co-Moderators:**

Robert R. Kuske, Jr., MD

Arizona Breast Cancer Specialists, Scottsdale, AZ

Ashwini Budrukkar, MD

Tata Memorial Hospital, Mumbai, India

11:30 am – 12:00 pm

**ABS Presidential Address:**

Brian J. Davis, MD, PhD

ABS President

12:00 noon – 1:00 pm

Lunch (attendees on their own)

12:00 noon – 1:00 pm

**Resident Luncheon**  
Sponsored by Oncura



**Speaker:**  
Kent E. Wallner, MD  
Puget Sound Health Care System, Seattle, WA

**MOC & SAM's**  
W. Robert Lee, MD  
Duke University Medical Center, Durham, NC

1:00 – 1:45 pm

**Ulrich Henschke Award**  
Sponsored by Best Medical International, Inc.



**Best Medical International, Inc.**  
Established 1977

**Ulrich Henschke Memorial Lecture**  
Michael J. Zelefsky, MD  
Memorial Sloan-Kettering Cancer Center  
New York, NY

1:45 – 3:00 pm

**Advances in Brachytherapy for Cervical Cancer**  
(Audience Response System)

**Moderator:**  
Nina A. Mayr, MD  
Arthur G. James Cancer Hospital at Ohio State, Columbus, OH

**Panelists:**  
**3D Image-Guided Brachytherapy in the U.S.**  
Akila N. Viswanathan, MD, MPH  
Brigham and Women's Hospital/Dana-Farber Cancer Institute,  
Boston, MA

**Uncertainties in MR Image-Guided Cervical Cancer  
Brachytherapy**  
Christian Kirisits, ScD  
Medical University of Vienna, Vienna, Austria

**Optimization in HDR Brachytherapy: Protocols and Pitfalls**  
Jason Rownd, MS  
Medical College of Wisconsin, Milwaukee, WI

1:45 – 3:00 pm  
(Parallel Session)

**Physics: Advanced Technology**  
**Co-Moderators:**  
Keith Furutani, PhD  
Mayo Clinic, Rochester, MN

Ivan Yeung, PhD  
Princess Margaret Hospital, Toronto, Ont., Canada

**Panelists:**  
**The Future of Imaging in Brachytherapy**  
David A. Jaffray, PhD  
Ontario Cancer Institute / Princess Margaret Hospital, Toronto,  
Ont., Canada

**The Future of Brachytherapy Physics in North America**  
Mark J. Rivard, PhD  
Tufts-New England Medical Center, Boston, MA



# Agenda

3:00 – 3:20 pm

3:20 – 4:30 pm

3:20 – 4:30 pm  
(Parallel Session)

4:30 – 5:30 pm

6:30 pm – 7:30 pm

## Monday, June 1

7:00 am – 5:00 pm

7:00 am – 5:00 pm

7:00 – 7:30 am

7:15 – 8:00 am

8:00 – 9:30 am

### The Future Role of Robotics in Brachytherapy

Aaron Fenster, PhD

Ontario Institute for Cancer Research, Toronto, Ont., Canada

### Refreshment Break

### GYN Proffered Papers I

#### Co-Moderators:

Caroline Holloway, MD

BC Cancer Agency, Vancouver Island Cancer Centre

Vancouver, BC, Canada

Sushil Beriwal, MD

University of Pittsburgh Medical Center, Pittsburgh, PA

### Physics Proffered Papers I

#### Co-Moderators:

Ingrid Spadinger, PhD

BC Cancer Research Center, Vancouver, BC, Canada

Marco Zaider, PhD

Memorial Sloan-Kettering Cancer Center, New York, NY

### Adjuvant Treatment for Endometrial Cancer. What to do Now?

Patricia J. Eifel, MD

MD Anderson Cancer Center, Houston, TX

### Welcome Reception, Poster Review and Exhibits in Exhibit Hall

### Registration

### Commercial Exhibits

### Continental Breakfast

### Breast Brachytherapy: Improving the Therapeutic Ratio

David E. Wazer, MD

Tufts New England Medical Center, Boston, MA

### Debates in Breast Brachytherapy (Audience Response System)

#### Moderator:

Rakesh Patel, MD

Western Radiation Oncology, Mountain View, CA

#### Panelists:

#### Should APBI Be Offered Off-clinical Trial?

#### PRO: APBI Is Ready For Prime-Time

Robert R. Kuske, Jr., MD

Arizona Breast Cancer Specialists, Scottsdale, AZ

#### PRO: Whole Breast Radiation Is the Standard of Care

*To be determined*

**Discussant:** Frank Vicini, MD

William Beaumont Hospital, Royal Oak, MI



**Optimal Technique of Accelerated Partial Breast Irradiation**

**PRO: Brachytherapy**

David E. Wazer, MD

Tufts New England Medical Center, Boston, MA

**PRO: External Beam RT**

Alphonse Taghian, MD

Harvard Medical School, Boston, MA

**Discussant: Doug Arthur, MD**

Virginia Commonwealth University, Richmond, VA

9:30 – 9:55 am

**Refreshment Break**

9:55 – 10:55 am

**Breast Proffered Papers II**

**Co-Moderators:**

Laurie Cuttino, MD

Virginia Commonwealth University, Richmond, VA

Jean-Philippe Pignol, MD

Sunnybrook Health Sciences Centre, Toronto, Canada

9:55 – 10:55 am

(Parallel Session)

**Prostate Proffered Papers II**

**Co-Moderators:**

Eric Vigneault, MD

Hôtel-Dieu de Québec, Quebec City, Quebec, Canada

Thomas G. Shanahan, MD, FACRO

University Radiology

Springfield, IL

11:00 – 12:10 pm

**Plenary Session**

**Co-Moderators:**

Brian J. Davis, PhD, MD

Mayo Clinic, Rochester, MN

Rakesh R. Patel, MD

Western Radiation Oncology, Mountain View, CA

12:15 – 1:40 pm

**ABS Member Lunch and ABS Annual Business Meeting**

(event for ABS members-only)

Sponsored by Theragenics

**THERAGENICS CORPORATION®**

1:40 – 2:40 pm

**Prostate Proffered Papers III**

**Co-Moderators:**

Josh Yamada, MD

Memorial Sloan-Kettering Cancer Center, New York, NY

Bradley Prestige, MD

Texas Cancer Clinic

San Antonio, TX

1:40 – 2:40 pm

(Parallel Session)

**Physics Proffered Papers II**

**Co-Moderators:**

Vrinda Narayana, PhD

Providence Cancer Institute, Southfield, MI

Raxa Sankrecha, MSc

Carlo Fidani Peel Regional Cancer Centre/Credit Valley Hospital,

Mississauga, Ont., Canada



# Agenda

2:40 – 4:00 pm

## **Prostate: Targeting Prostate Cancer (Audience Response System)**

### **Co-Moderators:**

Brian J. Davis, MD, PhD  
Mayo Clinic, Rochester, MN

Gregory S. Merrick, MD  
Schiffler Cancer Center, Wheeling Jesuit University, Wheeling, WV

### **Panelists:**

#### **Imaging Perspective**

Masoom Haider, MD  
University of Toronto, Toronto, Ont., Canada

#### **Pathologic Perspective and Surveillance**

Gregory S. Merrick, MD  
Schiffler Cancer Center, Wheeling Jesuit University, Wheeling, WV

#### **Targeted Therapy: Focal Brachytherapy**

I-Chow “Joe” Hsu, MD  
University of California at San Francisco, San Francisco, CA

#### **Targeted Therapy: Cryotherapy and HIFU**

Joseph L Chin, MD, FRCSC  
London Health Sciences Center/University of Western Ontario,  
Ont., Canada

2:40 – 4:00 pm  
(Parallel Session)

## **Physics: Heterogeneity Corrections in Brachytherapy**

### **Co-Moderators:**

Dorin Todor, PhD  
Virginia Commonwealth University, Richmond, VA

Ron S. Sloboda, PhD, FCCM  
Cross Cancer Institute, Edmonton, Alberta, Canada

### **Panelists:**

#### **Monte Carlo in Brachytherapy Planning Systems**

Luc Beaulieu, PhD  
Hôtel-Dieu de Québec, Quebec City, Quebec, Canada

#### **Accuracy of Collapsed Cone Convolution Calculations**

Asa Carlsson, PhD  
Linköping University, Linköping, Sweden

#### **Feasibility of Deterministic Transport Calculations**

Firas Mourtada, PhD  
MD Anderson Cancer Center, Houston, Texas

4:00 – 5:30 pm

## **Imaging the Radiation Response: Implications for Treatment (Audience Response System)**

### **Moderator:**

Patricia J. Eifel, MD  
MD Anderson Cancer Center, Houston, TX

### **Panelists:**

#### **Imaging of Cervical Cancer - Impact on Treatment Planning**

Mostafa Atri, MD  
University of Toronto, Toronto, Ont., Canada

**Adapting to Change: A Template for Improved Treatment of Cervix Cancer**

Michael Milosevic, MD  
Princess Margaret Hospital, Toronto, Ont., Canada

**3D Evaluation of Pelvic Anatomy and Movement**

Catheryn Yashar, MD  
University of California, San Diego, CA

**4:00 – 5:30 pm**  
(Parallel Session)

**Prostate Hands-On Workshops**

(concurrent sessions, registration is limited and will be on a first-come, first-served basis; registration is included in your registration fee)

**1) HDR Prostate Implants I**

- a) I-Chow “Joe” Hsu, MD  
University of California at San Francisco, San Francisco, CA
- b) Gerard C. Morton, MD  
Toronto-Sunnybrook Regional Cancer Center, Toronto, Ont., Canada

**2) HDR Prostate Implants II (Beyond CT: US or MRI)**

- a) Cynthia Menard, MD  
Princess Margaret Hospital, Toronto, Canada
- b) Gary Gustafson, MD  
William Beaumont Hospital, Royal Oak, MI

**3) LDR Real-Time Implants I**

- a) Thomas G. Shanahan, MD, FACRO  
University Radiologists, Springfield, IL
- b) Jamie A. Cesaretti, MD  
Florida Radiation Oncology Group, Jacksonville, FL

**4) LDR Real-Time Implants II**

- a) Steve Kurtzman, MD  
Western Radiation Oncology, Mountain View, CA
- b) Nelson Stone, MD  
Mount Sinai School of Medicine, New York, NY

**5) LDR Physics**

- a) Wayne M. Butler, PhD  
Schiffler Cancer Center/Wheeling Jesuit University,  
Wheeling, WV

**6) HDR Physics**

- a) Frank-André Siebert, PhD  
UKSH Campus Kiel, Kiel, Germany

**6:30 – 8:30 pm**

**Gala Event at the Hart House**  
(meet in hotel lobby from 6:00-6:15 pm)

**Tuesday, June 2**

**7:00 am – 12:30 pm**

**Registration**

**7:00 am – 12:00 pm**

**Commercial Exhibits**

**7:00 – 7:30 am**

**Continental Breakfast**

**7:30 – 9:00 am**

**Brachytherapy Show and Tell**  
**Co-Moderators:**  
Bradley R. Prestidge, MD



# Agenda

Texas Cancer Center, San Antonio, TX

Phillip Devlin, MD

Brigham and Women's Hospital/Dana-Farber Cancer Institute,  
Boston, MA

**Panelists:**

**Penile Brachytherapy**

Juanita M. Crook, MD, FRCPC

Princess Margaret Hospital, Toronto, Ont., Canada

**Rectal Brachytherapy**

Te Voung, MD

Research Institute of the McGill University Health Centre,  
Montreal, Que., Canada

**Head and Neck Brachytherapy**

Ken Hu, MD

Beth Israel Medical Center, New York, NY

**Lung Brachytherapy**

Deepak Khuntia, MD

University of Wisconsin, Madison, WI

**7:30 – 9:00 am**  
(Parallel Session)

**Physics: Achieving Quality in Brachytherapy**

**Co-Moderators:**

Anil Sharma, PhD, DRP

Long Beach Memorial Medical Center, Long Beach, CA

Gilad Cohen, MS

Memorial Sloan-Kettering Cancer Center, New York, NY

**Panelists:**

**The Challenges of Commissioning Brachytherapy Equipment**

Jack L.M. Venselaar, PhD

Dr. B. Verbeeten Institute, Tilburg, The Netherlands

**The Challenges of Quality Assurance for Advance Techniques**

Bruce R.Thomadsen, PhD

University of Wisconsin/Medical Physics and Human Oncology,  
Madison, WI

**9:00 – 10:00 am**

**Accelerated Partial Breast Irradiation Hands-On Workshops (two  
30 minute sessions)**

Concurrent sessions, registration is limited and will be on a first-come,  
first-served basis; registration is included in your registration fee

**1. Multi-Catheter Interstitial Technique**

Robert R. Kuske, Jr., MD

Arizona Breast Cancer Services

Scottsdale, AZ

**2. MammoSite Balloon Brachytherapy**

Martin E. Keisch, MD

Cedars Medical Center

Miami, FL

**3. Contura Multi-lumen Balloon**

Douglas Arthur, MD

VCU Medical Center / Massey Cancer Center

Richmond, VA

**4. ClearPath**

Peter D. Beisch, MD, FACS  
Dallas Surgical Group  
Dallas, TX

**5. XOFT**

Adam Dickler, MD  
Little Company of Mary  
Evergreen Park, IL

**5. SAVI**

Catheran Yashar, MD  
University of California, San Diego  
San Diego, CA

**9:00 – 10:00 am**  
(Parallel Session)

**GYN Proffered Papers II**

**Co-Moderators:**

David P. D'Souza, MD  
London Regional Cancer Center, London, Ont., Canada

Jorgen L. Hansen, MS  
Brigham and Women's Hospital/Dana-Farber Cancer Institute Boston, MA

**10:00 – 10:20 am**

**Refreshment Break**

**10:20 – 11:20 am**

**Physics Proffered Papers III**

**Co-Moderators:**

Jean Pouliot, PhD  
University of California-SF, San Francisco, CA

Michael Evans, MD  
Montreal General Hospital, Montreal, Que., Canada

**10:20 – 11:20 am**  
(Parallel Session)

**Miscellaneous Proffered Papers**

**Co-Moderators:**

Phillip Devlin, MD  
Brigham and Women's Hospital/Dana-Farber Cancer Institute, Boston, MA

Subhakar Mutyala, MD  
Montefiore Medical Center, New York, NY

**11:20 am – 12:30 pm**

**Extreme Hypofractionation versus Brachytherapy**

**Moderator:**

Kent E. Wallner, MD  
Puget Sound Health Care System, Seattle, WA

**Panelists:**

**External Radiation**

Don Fuller, MD  
Cyberknife Center of San Diego, San Diego, CA

**HDR Monotherapy**

Gary Gustafson, MD  
William Beaumont Hospital, Royal Oak, MI

**Informed Consent**

Kent E. Wallner, MD  
Puget Sound Health Care System, Seattle, WA

**12:30 pm**

**Meeting Adjourns**



# 2009 Annual Meeting

## Function Space Key

Day / Time	Event	Function Room / Location
<b>Saturday to Tuesday</b>		
1:00-6:00 pm	Registration	Metro Ballroom Foyer / Conference Centre
<b>Sunday</b>		
7:00 am-4:30 pm	Exhibits / Breakfast / Breaks / Posters	Metro Ballroom West & Centre / Conference Centre
	<b>General Sessions</b>	<b><u>Metro Ballroom East / Conference Centre</u></b>
7:30 am	Prostate Brachytherapy	
8:30 am	High-Risk Prostate Cancer	
10:10 am	Break	<u>Metro Ballroom West &amp; Centre / Conference Centre</u>
10:30 am	Prostate Proffered Papers Session 1	
11:30 am	ABS Presidential Address	
1:00 pm	ABS Ulrich Henschke Award and Henschke Memorial Lecture	
1:45 pm	Advances for Cervical Cancer	
3:00 pm	Break	<u>Metro Ballroom West &amp; Centre / Conference Centre</u>
3:20 pm	GYN Proffered Papers Session 1	
4:30 pm	Endometrial Cancer	
	<b>Parallel Sessions</b>	<b><u>Pier 4 Room / Hotel Convention Level</u></b>
10:30 am	Breast Proffered Papers Session 1	
1:45 pm	Physics: Advanced Technology	
3:20 pm	Physics Proffered Paper Session 1	
	Speaker Ready Room	Yonge Room / Conference Centre
	Faculty Room	Bay Room / Conference Centre
Noon-1:00 pm (for Residents only)	Residents' Luncheon	Pier 5 Room / Hotel Convention Level
Noon-1:00 pm	AAPM Brachytherapy Subcommittee	Quay Room / Conference Centre
5:30 pm	ABS Board Meeting	Pier 9 Room / Hotel Convention Level
6:30-7:30 pm	Welcome Reception	Metro Ballroom West & Centre / Conference Centre
<b>Monday</b>		
7:00 am-5:00 pm	Exhibits / Breakfast / Breaks / Posters	Metro Ballroom West & Centre / Conference Centre
	<b>General Sessions</b>	<b><u>Metro Ballroom East / Conference Centre</u></b>
7:15 am	Breast Brachytherapy	
8:00 am	Breast Brachytherapy Debate	
9:30 am	Break	<u>Metro Ballroom West &amp; Centre / Conference Centre</u>
9:55 am	Breast Proffered Papers 2	
11:00 am	Plenary Session	
1:40 pm	Prostate Proffered Papers Session 3	
2:40 pm	Targeting Prostate Cancer	
4:00 pm	Imaging the Radiation Response	

Day / Time	Event	Function Room / Location
	<b>Parallel Sessions</b>	<b><u>Pier 4 Room / Hotel Convention Level</u></b>
9:55 am 1:40 pm 2:40 pm	Prostate Proffered Papers 2 Physics Proffered Papers Session 2 Physics: Heterogeneity Corrections	
	Speaker Ready Room Faculty Room	Yonge Room / Hotel Convention Level Bay Room / Conference Centre
12:15-1:40 pm	ABS Annual Business Meeting and ABS Membership Lunch (ABS members only)	Regatta Room / Hotel Lobby Level
4:00-5:30 pm	<b><u>Prostate Hands-On Workshops:</u></b> 1) HDR Prostate Implants 1 2) HDR Prostate Implants 2 3) LDR Real-Time Implants 1 4) LDR Real-Time Implants 2 5) LDR Physics 6) HDR Physics	Queens Quay 1 / Hotel Lobby Level Queens Quay 2 / Hotel Lobby Level Pier 2 Room / Hotel Convention Level Pier 3 Room / Hotel Convention Level Pier 5 Room / Hotel Convention Level Pier 6 Room / Hotel Convention Level
4:30-6:00 pm	ABS Physics Committee	Pier 7 Room / Hotel Convention Level
6:30-8:30 pm	Gala Event	At The Hart House; meet in hotel lobby from 6:00 to 6:15 pm for bus service
<b>Tuesday</b>		
7:00 am-12:00 pm	Exhibits / Breakfast / Breaks / Posters	Metro Ballroom West & Centre / Conference Centre
	<b>General Sessions</b>	<b><u>Metro Ballroom East / Conference Centre</u></b>
7:30 am 10:00 am 10:20 am 11:20 am	Brachytherapy Show and Tell Break Physics Proffered Papers 3 Extreme Hypofractionation	<u>Metro Ballroom West &amp; Centre / Conference Centre</u>
	<b>Parallel Sessions</b>	<b><u>Pier 4 Room / Hotel Convention Level</u></b>
7:30 am 9:00 am 10:20 am	Physics: Achieving Quality GYN Proffered Papers 2 Miscellaneous Proffered Papers	
9:00-10:00 am	<b><u>Accelerated PBI Hands-On Workshops:</u></b> 1) Multi-Catheter Interstitial 2) MammoSite Balloon 3) Contura Multi-Lumen Balloon 4) ClearPath 5) Xoft 6) SAVI	Queens Quay 1 / Hotel Lobby Level Queens Quay 2 / Hotel Lobby Level Pier 2 Room / Hotel Convention Level Pier 6 Room / Hotel Convention Level Pier 3 Room / Hotel Convention Level Pier 7 Room / Hotel Convention Level
	Speaker Ready Room Faculty Room	Yonge Room / Hotel Convention Level Bay Room / Conference Centre

# Oncura 2009 Seattle Prostate Brachytherapy Fellowship Recipients



**Christopher J. Anker, MD**  
Huntsman Cancer Hospital  
Salt Lake City, UT

**Thomas P. Boike, MD**  
University of Texas Southwestern  
Dallas, TX

**Felix Yi-Chung Feng, MD**  
University of Michigan Medical  
Center  
Ypsilanti, MI

**Siavash Jabbari, MD**  
University of California  
San Francisco  
San Francisco, CA

**Baoqing Li, MD, PhD**  
University of California Davis  
UC Davis Cancer Center  
Sacramento, CA

**Akash Nanda, MD, PhD**  
Harvard Radiation Oncology  
Program  
Boston, MA

**Thomas Pugh, MD**  
University of Colorado  
Denver, CO

**Daniel C. Schiffner, MD**  
University of California Irvine  
Marina Del Rey, CA

**Kevin L. Stephans, MD**  
Cleveland Clinic Foundation  
Cleveland, OH

**Tiffany Tam, MD**  
Juravinski Cancer Centre  
Burlington, Ontario, Canada

**Houman Vaghefi, MD**  
University of Southern California  
Los Angeles, CA

**Ruijie Yang, PhD**  
Peking University Third Hospital  
Beijing, China

**James Yu, MD**  
Yale University School of Medicine  
New Haven, CT

# Nucletron 2009 Texas Cancer Clinic HDR Brachytherapy Fellowship Recipients



# Nucletron

**Siddhartha Baxi, MD**  
Princess Alexandra Hospital  
Queensland, Australia

**John Christodouleas, MD, MPH**  
Johns Hopkins Hospital  
Baltimore, MD

**Karen H. Cohen, MD**  
Baylor College of Medicine  
Houston, TX

**Megan DeHaan, MD**  
Kaiser Permanente  
Los Angeles, CA

**Felix Yi-Chung Feng, MD**  
University of Michigan  
Ypsilanti, MI

**Vimoj Nair, J, MD**  
Pandit B.D. Sharma Post  
Graduate  
Institute of Medical Sciences  
Rohtak, Haryana, India

**Brandon Patton, MD**  
University of Miami  
Miller School of Medicine  
Miami Beach, FL

**Leonardo Vieira Poli, MD**  
Santa Casa de Misericordia de  
Porto Alegre  
Brazil

**Eswaran Prasad**  
Christian Medical College  
Vellore, India

**Andrew Owen Wahl, MD**  
Nebraska Medical Center  
Omaha, NE



# Oncura 2009 Resident Travel Grant Award Recipients

**Jarrold Adkison, MD**

Five-Year Results Of Accelerated Partial Breast Irradiation For Ductal Carcinoma In Situ Treated By Interstitial Multi-Catheter HDR Brachytherapy Or Mammosite

**J. Adam Cunha, PhD**

Inverse-Planned Image-Guided Robotic Brachytherapy: Pre-Clinical Proofs Of Principle

**Ramez Eskander, MD**

Comparison Of CT And MRI Cervical Cancer Brachytherapy Target And Normal Tissue Volumes

**Nataliya Kovalchuk, PhD**

Dosimetric Effect Of Interfractional Catheter Displacement In Prostate High-Dose-Rate (HDR) Brachytherapy

**Sayan Kundu, MBBS**

High Dose Rate Intracavitary Brachytherapy In Locally Advanced Uterine Cervix Cancer Using Three Different Fractionation Schedules: An Indian Experience

**Robert Markelewicz, MD, MMSc**

A Comparison Of The Biological Effective Dose (Bed) Of 50kv Electronic Brachytherapy To Iridium-192 High-Dose Rate Brachytherapy For Vaginal Cuff Irradiation

**Jyoti Mayadev, MD**

Permanent Prostate Brachytherapy In Prostate Glands Less Than 20 Cm<sup>3</sup>

**Priti Patel, MD**

Seroma Is An Expected Consequence And Not A Complication Of MammoSite Brachytherapy

**Andrea Rottenfusser, MD**

Treatment Of Locally Advanced Vaginal Cancer With Radio-Chemotherapy And MRI-Guided Brachytherapy: Clinical Feasibility And First Results

**Shirin Sioshansi, MD**

A Dosimetric Comparison Of Accuboot Non-Invasive Partial Breast Brachytherapy To Electron Beam Tumor Bed Boost And 3-D Conformal APBI

**Kevin Stephans, MD**

Evaluation Of Long-Term Bowel And Urinary Toxicity After Permanent Prostate Brachytherapy

**Alina Sturdza, MD**

Clinical Impact Of Dose Volume Adaptation And Dose Escalation In MRI-Guided HDR Brachytherapy Including The Use Of Combined Intracavitary/Interstitial Techniques For Patients With Poor Response Cervical Cancer FIGO Stage IIB Or IIIB

**Jamema Swamidas, MSc, Dip. RP**

Loading Pattern Calculated By Inverse Optimization Vs. Traditional Dosimetry Systems Of Intracavitary Brachytherapy Of Cervical Cancer - A Dosimetric Study

**Manpreet Tiwana, MD**

Spatial Distribution And Dvh Parameters Correlation Of Additional Rectal/Sigmoid Mucosal Points, In High Dose Rate Intracavitary Brachytherapy (ICA-HDR) For Carcinoma Cervix - A Dosimetric Study

**Robyn Vera, DO**

Does Treatment Time Or Source Strength Affect Late Toxicity In Accelerate Partial Breast Irradiation (APBI) Brachytherapy?



## 2009 ABS Ulrich Henschke Award: Michael J. Zelefsky, M.D.



It is a pleasure to honor Dr. Zelefsky with the 2009 ABS Ulrich Henschke Award. The Henschke Award is the most prestigious award presented by the ABS in recognition of contributions made to the profession.

Dr. Michael Zelefsky received his M.D. degree from the Albert Einstein College of Medicine in New York in 1986. He completed his Residency at Memorial Sloan-Kettering Cancer Center (MSKCC) in New York where he was the Chief Resident between 1989 and 1990. He was then subsequently appointed to the faculty of the Department of Radiation Oncology, where he has devoted most of his clinical research to the area of prostate and head and neck cancer.

Dr. Zelefsky was appointed Chief of the Brachytherapy Service at MSKCC in 1997. He helped develop and pioneer intraoperative conformal planning for prostate brachytherapy at that time, which incorporated sophisticated inverse-planning algorithms and intraoperative dose-volume histogram tools for enhancing the quality of low-dose-rate prostate brachytherapy. These innovations were then adapted into commercially available systems to allow for real-time planning. These innovations have further enhanced the ability of the brachytherapist throughout the world to perform more consistently higher quality brachytherapy procedures, which has in turn led to improved clinical outcomes. Dr. Zelefsky has also made important contributions to the field exploring uses of brachytherapy and its integration with functional imaging such as magnetic resonance imaging spectroscopy, as well as the role of dose escalation and intensity-modulated radiation therapy in the management of prostate cancer. He continues to explore with his colleagues the use of enhanced real-time high-precision methods of seed implantation and high-dose rate brachytherapy.

Dr. Zelefsky is currently Professor of Radiation Oncology and remains a prolific, internationally recognized and respected clinician and clinical researcher. Dr. Zelefsky is the author of well over 200 peer-reviewed papers, mostly in the area of genitourinary oncology. He has served the American Brachytherapy Society (ABS) for many years with great distinction. In addition to being a Board Member and the Society's Secretary and Treasurer (2000-2002), Dr. Zelefsky served as the Society's President and Chairman of the Board between 2003 and 2005. He was the Scientific Program Coordinator for the highly successful International Meeting for ABS and Groupe Européen de Curiethérapie–European Society for Therapeutic Radiology and Oncology (GEC ESTRO), which took place in Barcelona in 2004. This meeting served as a critical milestone for establishing strong ties that continue to exist between the two societies.

Dr. Zelefsky is currently the Editor-in-Chief of Brachytherapy, the official journal of the ABS. Now in its 8th extraordinarily successful year, the journal is the only one of its kind devoted to brachytherapy and recognized for its high-quality, peer-reviewed publications. It achieved Medline status early on and has brought further recognition to the ABS as the pre-eminent society in the world for representing brachytherapy in oncology.

Dr. Zelefsky lives with his wife and four children in Manhattan. He is an accomplished musician who enjoys playing the piano for relaxation.

# 2009 Annual Meeting Exhibitors

The American Brachytherapy Society and participating societies extend a sincere thank you to all of our corporate supporters and we encourage all attendees to visit with our exhibitors over the course of the meeting.

Company	Booth Number	Tabletop
Advanced Radiation Therapay / AccuBoost		C
Bard Urological Division	208	
Best Medical International	217	
B-K Medical Systems, Inc.	212	
Brachysciences	210	
BrachySolutions / PDS	215	
Calypso Medical Technologies		B
Cianna Medical	213	
Civco Medical Systems		A
Core Oncology	111	
Diacor, Inc.	314	
Elsevier Publishing	206	
Envisioneering Medical		H
EUSA Pharma (USA), Inc.		F
Harvard Medical School		E
Hitachi Medical Systems America	109	
Hologic		D
IBt-BEBIG		L
IsoAid LLC	203	
IsoDose Control	103	
IsoRay Medical, Inc.	207	
Lippincott William & Wilkins		G
Mick Radio Nuclear Instruments, Inc.	211	
MUCHeck, Oncology Data Systems		I
Nucletron	306	
Oncura	202	
Revenue Cycle		J
SenoRX	302	
Sirtex Medical Inc.		K
Theragenics Corporation	310	
Varian BrachyTherapy	115	
Xoft, Inc.	209	

**Meet Our Exhibitors and Be Eligible for Prize Drawings!**  
Your attendee envelope includes a signature card for each exhibiting company. Get your card completely filled out and turn it in to the ABS registration desk by 5:00 pm on Monday afternoon. On Tuesday morning there will be three prize drawings for those eligible to participate. Prizes will include two I-Pods!



# Exhibitor Floor Plan

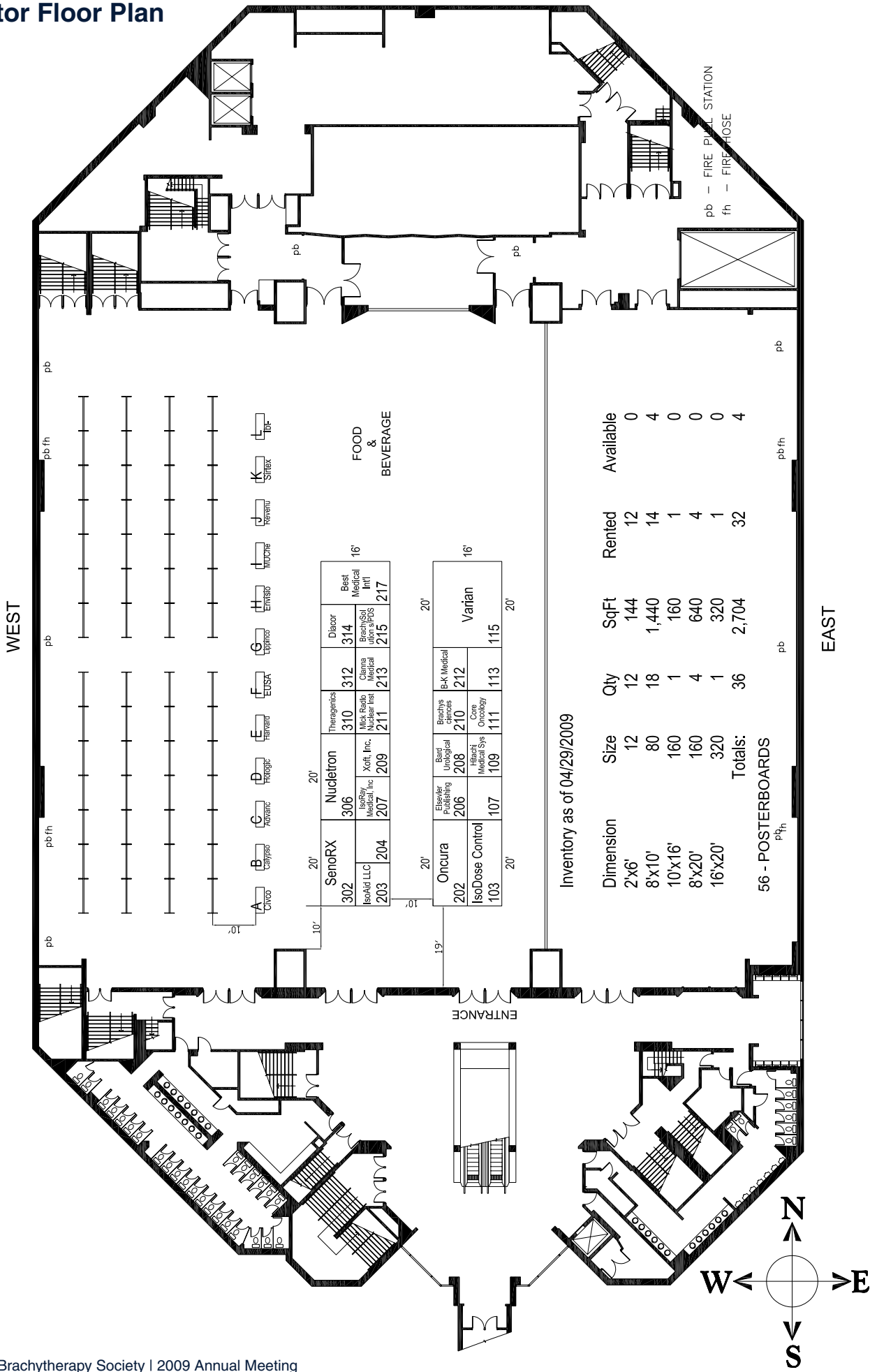

WEST

EAST

FOOD & BEVERAGE

Inventory as of 04/29/2009

Dimension	Size	Qty	SqFt	Rented	Available
2'x6'	12	12	144	12	0
8'x10'	80	18	1,440	14	4
10'x16'	160	1	160	1	0
8'x20'	160	4	640	4	0
16'x20'	320	1	320	1	0
<b>Totals:</b>		<b>36</b>	<b>2,704</b>	<b>32</b>	<b>4</b>

56 - POSTERBOARDS  
p<sub>th</sub>

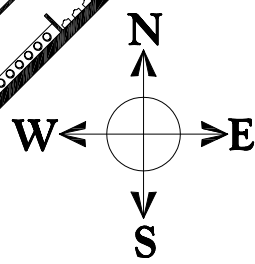

## **Future ABS Annual Meetings**

**2010: April 29 - May 1 | Hyatt Regency Atlanta**

**2011: April 14 - 16 | Manchester Grand Hyatt, San Diego**

**2012: World Congress of Brachytherapy**

## **Future ABS Educational Schools**

**2009 GYN School: June 28-29 | Knickerbocker Hotel, Chicago, IL**



**2010 Annual Meeting: Atlanta**



# Notes

# Floor Plan | Weston Harbor Castle | Toronto

