



AMERICAN BRACHYTHERAPY SOCIETY  
**Annual Meeting**  
June 13–15, 2019

**InterContinental Miami, Miami, FL, USA**

**#ABSBACHY19**

**KNOWLEDGE IS POWER: Generating  
Awareness for Patients & Practitioners**

American Brachytherapy Society | [www.americanbrachytherapy.org](http://www.americanbrachytherapy.org)





## ABS Board of Directors

---

### President

**Peter F. Orio, III, DO, MS**  
Dana-Farber/Brigham and  
Women's Cancer Center  
Boston, MA

### President-Elect

**Daniel G. Petereit, MD, FASTRO**  
Rapid City Regional Hospital  
Rapid City, SD

### Vice President

**Firas Mourtada, PhD**  
Christiana Care Health System  
Newark, DE

### Secretary

**Zoubir Ouhib, MS, DABR, FABS**  
Lynn Cancer Institute  
Delray Beach, FL

### Treasurer

**Ann Klopp, MD, PhD**  
UT MD Anderson Cancer Center  
Houston, TX

### Chairwoman of the Board

**Catheryn Yashar, MD, FABS**  
University of California  
La Jolla, CA

## ABS Board Members-at-Large

---

### Sushil Beriwal, MD

University of Pittsburgh  
Pittsburgh, PA

### Christopher L. Deufel, PhD

Mayo Clinic  
Rochester, MN

### Peter J. Rossi, MD

Calaway Young Cancer Center  
at Valley View Hospital  
Glenwood Springs, CO

### Timothy N. Showalter, MD, MPH

The University of Virginia  
Charlottesville, VA

## Annual Meeting Learning Objectives:

---

1. Discuss established and emerging indications for brachytherapy treatment for cancer.
2. Review technical approaches for brachytherapy source and applicator insertion.
3. Review the current American Brachytherapy Society's guidelines for brachytherapy and the literature supporting these modalities, controversies, available methods and toxicities.
4. Understand new imaging modalities and how these can impact brachytherapy procedures and treatment planning.
5. Describe the potential role of social media in a modern brachytherapy practice.
6. Learn about strategies for incorporating peer review into a brachytherapy practice.
7. Understand the changing healthcare environment and how it will impact reimbursement for brachytherapy.
8. Obtain knowledge and hands-on experience in anatomy and organ segmentation in both prostate and gynecologic carcinoma as well as application of brachytherapy for skin cancers.
9. Learn about the current capabilities of brachytherapy treatment planning systems.
10. Understand modern brachytherapy treatment devices and how these can impact patient care.
11. Understand the current data regarding different fractionation schedules and clinical implications of different approaches.

## 2019 Ulrich Henschke Award



Presented to: **Gregory S. Merrick, MD, FABS**

After completion of training at Temple University and The George Washington University, Gregory S. Merrick, MD joined the Schiffler Cancer Center at Wheeling Hospital. His clinical practice and research focuses on the diagnosis, treatment, quality of life and impact of exercise on prostate cancer outcomes.

He has advanced prostate brachytherapy patient selection and treatment outcomes including morbidity, has participated in multiple phase III drug trials for castrate resistant metastatic prostate cancer, has evaluated methods to improve percutaneous renal cryosurgery and has utilized comprehensive transperineal biopsy techniques to improve patient selection and freedom from treatment in active surveillance patients. In conjunction with his colleague, Dr. Kent Wallner, Merrick has completed four prospective randomized prostate brachytherapy trials. He founded the Men's Health Center and the Urologic Research Institute at Wheeling Hospital and Wheeling Jesuit University, which focuses on improving health through research, prevention and outreach strategies. He is the past chairman of the multi-disciplinary American College of Radiology Prostate Cancer Appropriateness Committee and past president and chairman of the board of the American Brachytherapy Society. He is a Fellow of the American College of Radiology and the American Brachytherapy Society. Currently, he is the genito-urinary section editor of the journal *Brachytherapy*. He has published approximately 300 original scientific studies, edited two prostate brachytherapy textbooks and has lectured across the United States and abroad.

Away from medicine, Merrick is the founder of CRC Basketball, which encompasses player development, coaching instruction and the annual Cancer Research Classic (a national invitational high school basketball tournament televised on ESPN). His knowledge of the game, passion and excellent communication skills have made him a sought after clinician and speaker. Merrick has worked with players from middle school through the professional ranks and has been instrumental in preparing numerous high school athletes both academically and athletically for college basketball. He developed *Moving Up*, a didactic seminar for student athletes and their parents detailing the physical, mental and academic skills necessary for college basketball. In the greater Wheeling community, he developed health care clinics for the underserved, an afterschool academic program for high risk students and later this year will be honored by the YMCA with their highest honor—Light of the Valley—for his contributions to area youth.

## Keynote Speaker | **Honorable Edward K. Newman**

From the gridiron to the courtroom, the honorable Edward Newman is recognized for his athletic abilities the with the Dolphins. He went on to play 12 seasons (1973 to 1984) for Coach Don Shula (one Super Bowl world champion, two American Football Conference champion, four times All-Pro (1981, 1982, 1983, and 1984), 167 games played, 113 started.) Ed reluctantly retired from pro-football after a knee injury in 1985. In 2014, the Dolphins dedicated a star at the Dolphins' stadium "Walk of Fame," in recognition of Ed's contributions as a player and for the community. In 2015, the Dolphins recognized Ed as one of the top 50 ball players to strap on the cleats in the first 50 years of the Dolphin franchise.

Judge Newman is 2 time cancer survivor and exemplifies our theme this year, *Knowledge is Power: Generating Awareness for Patients & Practitioners*.





# 2019 Annual Conference Scientific Program Chair

## Invited Faculty

### **Kevin Albuquerque, MD**

UTSW Radiation Oncology | Dallas, TX

### **Bethany M. Anderson, MD**

University of Wisconsin | Madison, WI

### **Douglas W. Arthur, MD, FASTRO, FABS**

Virginia Commonwealth University  
School of Medicine | Richmond, VA

### **Diandra N. Ayala-Peacock, MD**

Vanderbilt University School of Medicine  
Nashville, TN

### **Maryann O. Ayoade, MS, PhD**

U.S. Nuclear Regulatory Commission  
King of Prussia, PA

### **Christopher A. Barker, MD**

Memorial Sloan Kettering Cancer Center  
New York, NY

### **Parul N. Barry, MD**

Rush University Medical Center | Chicago, IL

### **Luc Beaulieu, PhD**

CHU De Québec – UQV | Quebec City, Canada

### **Kristin Bradley, MD**

University of Wisconsin School of Medicine  
Madison, WI

### **Wayne M. Butler, PhD, FABS**

Schiffler Cancer Center/Wheeling Hospital  
Wheeling, WV

### **Ivan Buzurovic, PhD**

Dana Farber Brigham Women's Cancer Center  
Montreal, QC

### **\*Albert J. Chang, MD, PhD**

UCLA | Los Angeles, CA

### **Peter Y. Chen, MD, FACR, FASTRO**

Beaumont Health System | Royal Oak, MI

### **\*Junzo P. Chino, MD**

Duke University Medical Center | Durham, NC

### **\*Gil'ad N. Cohen, MS**

Memorial Sloan-Kettering Cancer Center  
New York, NY

### **Daniel Costa, MD**

UT Southwestern Medical Center | Dallas, TX

### **Adam M. Cunha, PhD**

UCSF Comprehensive Cancer Center  
San Francisco, CA

### **Hans Chung, MD, FRCPC**

Sunnybrook Odette Cancer Centre | Toronto, ON

### **Bradley Corr, MD**

University of Colorado School of Medicine  
Aurora, CO

### **Shari Damast, MD**

Yale School of Medicine | New Haven, CT

### **Robert B. Den, MD, MS**

Thomas Jefferson University Hospital  
Philadelphia, PA

### **Neil B. Desai, MD, MHS**

University of Texas Southwestern | Dallas, TX

### **\*Christopher L. Deufel, PhD**

Mayo Clinic | Rochester, MN

### **Rodney J. Ellis, MD**

University Hospitals Seidman Cancer Center  
Pepper Pike, OH

### **Mohamed A. Elshaikh, MD**

Henry Ford Hospital | Detroit, MI

### **Shirin A. Enger, PhD**

McGill University | Montreal, QC

### **Beth A. Erickson, MD, FACR, FASTRO, FABS**

Medical College of Wisconsin | Milwaukee, WI

### **Emma C. Fields, MD**

Virginia Commonwealth University | Richmond, VA

### **\*Christine M. Fisher, MD, MPH**

University of Colorado Denver | Aurora, CO

### **\*Michael R. Folkert, MD, PhD**

UT Southwestern Medical Center | Dallas, TX

### **Steven J. Frank, MD**

UT MD Anderson Cancer Center | Houston, TX

### **David K. Gaffney, MD, PhD, FACR, FASTRO**

University of Utah | Salt Lake City, UT

### **Scott M. Glaser, MD**

City of Hope | Duarte, CA

### **Christian V. Guthrie, PhD**

Brigham and Women's Hospital | Boston, MA

### **Matthew M. Harkenrider, MD**

Stritch School of Medicine  
Loyola University Chicago | Maywood, IL

### **Thomas Harris, PhD**

Brigham and Women's Hospital | Brookline, MA

### **Lara Hathout, MD, FRCPC**

Rutgers Cancer Institute of NJ | New Brunswick, NJ

### **Jaroslav T. Hepel, MD**

Rhode Island Hospital/Brown University  
Providence, RI

### **Robert F. Hobbs, PhD**

John Hopkins University | Baltimore, MD

### **Kathleen C. Horst, MD**

Stanford University Medical Center | Stanford, CA

### **Nadine Housri, MD**

Yale University School of Medicine | New Haven, CT

### **I-Chow Hsu, MD, FACR, FASTRO**

UCSF Comprehensive Cancer Center  
San Francisco, CA

### **Brian Hrycushko, PhD**

UT Southwestern Medical Center | Dallas, TX

### **Anne Hubbard, MBA**

The American Society for Radiation Oncology  
Arlington, VA

### **Xun Jia, PhD**

UTSW Radiation Oncology | Dallas, TX

### **Ashesh Jani, MD, MSEE, FASTRO**

Winship Cancer Institute of Emory University  
Atlanta, GA

### **Melissa Joyner**

MD Anderson Cancer Center | Houston, TX

### **Noah Kalman, MD**

Miami Cancer Institute at Baptist Health South Florida  
Miami, FL

### **\*Mitchell Kamrava, MD**

Cedars-Sinai Medical Center | Los Angeles, CA

### **Martin T. King, MD, PhD**

Brigham and Women's Hospital | Boston, MA

### **Ann Klopp, MD, PhD**

UT MD Anderson Cancer Center | Houston, TX

### **Miriam Knoll, MD**

Hackensack UMC/Mountainside | Woodmere, NY

### **Marisa Ariane Kollmeier, MD**

Memorial Sloan-Kettering Cancer Center  
New York, NY

### **Robert R. Kuske, Jr., MD**

Arizona Breast Cancer Specialists | Scottsdale, AZ

### **Anna Likhacheva, MD, MPH**

Sutter Health | Sacramento, CA

### **Alvaro A. Martinez, MD, FACR, FABS**

MHP Radiation Oncology Institute  
Farmington Hills, MI

### **Mahta M. Mckee, MS**

Wake Forest University | Winston Salem, NC

### **Patrick William McLaughlin, MD**

University of Michigan/Providence Cancer Center  
Novi, MI

### **Najeeb Mohideen, MD, FASTRO**

Northwest Community Hospital  
Arlington Heights, IL

**Pranshu Mohindra, MD, MBBS, DABR**

University of Maryland School of Medicine  
Baltimore, MD

**Brian J. Moran, MD, FABS**

Chicago Prostate Cancer Center | Westmont, IL

**Firas Mourtada, PhD**

Christiana Care Health System | Wilmington, DE

**Peter F. Orio, III, DO, MS**

Dana-Farber Brigham and Women's Cancer Center  
Boston, MA

**Zoubir Ouhib, MS, DABR, FABS**

Lynn Cancer Institute | Delray Beach, FL

**Dawn Owen, MD**

University of Michigan Medical Center  
Ann Arbor, MI

**Sephahie Patel, MD**

Moffitt Cancer Center | Tampa, FL

**Tiffany Phillips, PhD**

Cedars-Sinai Medical Center | Los Angeles, CA

**Julio M. Pow-Sang, MD**

Moffitt Cancer Center | Tampa, FL

**Bradley R. Prestidge, MD, MS, FABS**

Bon Secours Oncology | Norfolk, VA

**Joann I. Prisciandaro, PhD**

University of Michigan Medical Center  
Ann Arbor, MI

**Sanoj Punnen, MD, MAS**

University of Miami, Miller School of Medicine  
Miami, FL

**Omar M. Ragab, MD**

Keck School of Medicine of USC | Los Angeles, CA

**Ananth Ravi, PhD, MCCPM**

Sunnybrook Odette Cancer Centre | North York, ON

**Mark J. Rivard, PhD, FAAPM, FABS**

Rhode Island Hospital/Brown University  
Providence, RI

**Melinda Roach, RN, BSN**

Virginia Commonwealth University  
Health System | Richmond, VA

**Peter J. Rossi, MD**

Calaway Young Cancer Center at Valley View Hospital  
Glenwood Springs, CO

**Kunal Saigal, MD**

Advent Health Cancer Institute | Orlando, FL

**Parag R. Sanghvi, MD, MSPH**

University of California San Diego | La Jolla, CA

**Matthew Scala, MD**

Kaiser Permanente | Santa Clara, CA

**Daniel J. Scanderbeg, PhD**

University of California San Diego | La Jolla, CA

**\*Jessica Schuster, MD**

University of Wisconsin | McFarland, WI

**\*Chirag S. Shah, MD**

Cleveland Clinic | Brecksville, OH

**Daya Nand Sharma, MD, DNB**

All India Institute of Medical Sciences (AIIMS)  
New Delhi, India

**Timothy N. Showalter, MD, MPH**

The University of Virginia | Charlottesville, VA

**Lisa Singer, MD, PhD**

Dana-Farber Cancer Institute | Boston, MA

**\*Daniel Y. Song, MD**

Johns Hopkins University | Highland, MD

**Daphna Y. Spiegel, MD**

Beth Israel Deaconess Medical Center | Boston, MA

**Alexandra J. Stewart, DM, MRCP, FRCR**

St Luke's Cancer Centre, Royal Surrey  
County Hospital | Guilford, Surrey, UK

**Matthew T. Studenski, PhD, DABR**

University of Miami | Miami, FL

**Gita Suneja, MD, MSHP**

Duke University School of Medicine | Durham, NC

**Amandeep Taggar, MD, MS**

Sunnybrook Odette Cancer Centre | Toronto, ON

**Chad Tang, MD**

MD Anderson Cancer Center | Houston, TX

**Neil K. Taunk, MD, MS**

University of Pennsylvania | Philadelphia, PA

**Nikhil G. Thaker, MD**

Arizona Oncology | Tucson, AZ

**Dorin A. Todor, PhD**

Virginia Commonwealth University  
Health System | Richmond, VA

**Alfredo I. Urdaneta, MD**

Virginia Commonwealth University  
Health System | Richmond, VA

**Puja S. Venkat, MD**

UCLA | Los Angeles, CA

**Frank A. Vicini, MD, FACR, FABS**

21st Century Oncology | Farmington Hills, MI

**Marianne Weiler, MBA, RT(T)**

Brigham and Women's Hospital/Dana Farber Cancer  
Institute | Boston, MA

**Jessica Wobb, MD**

Kettering Cancer Care | Hamilton, OH

**Catheryn M. Yashar, MD, FACRO, FABS**

University of California, San Diego | La Jolla, CA

**Lalaine Borja Zaide, PA-C**

UCLA Brachytherapy | Los Angeles, CA

**Michael J. Zelefsky, MD**

Memorial Sloan-Kettering Cancer Center  
New York, NY

**Scientific Program Chairs**

**Brett Cox, MD** | 2019 Annual Conference Scientific  
Program Chair

**Kristin A. Bradley, MD** | 2019 Annual Conference  
Scientific Vice-Chair

**Prostate**

**Michael Folkert, MD, PhD** | Chair

**Daniel Song, MD** | Vice-Chair

**GYN**

**Junzo Chino, MD** | Chair

**Christine Fisher** | Vice-Chair

**Skin**

**Parag Sanghvi** | Chair

**Anna Likhacheva** | Vice-Chair

**Breast**

**Chirag Shah** | Chair

**Jessica Schuster** | Vice-Chair

**Physics**

**Chris Deufel** | Chair

**Gil Cohen, PhD** | Vice-Chair

**Miscellaneous**

**Mitchell Kamrava, MD** | Chair

**Martin King** | Vice-Chair

**Socioeconomics**

**Nikhil Thaker** | Chair

**Albert Chang** | Vice-Chair

*\*Indicates 2019 Scientific Planning Committee*





## ABS 2019 Class of Fellows

The Board of Directors of the American Brachytherapy Society congratulates the **2019 class of ABS Fellows (FABS)**. This is a significant designation bestowed by the ABS, and is a tribute to the following recipients for their contributions and accomplishments in the field of brachytherapy.

**William S. Bice, PhD, FABS**

**Mira Keyes, MD, FRCPC, FABS**

**Gerard C. Morton, MD, FRCPC, FABS**

**John E. Sylvester, MD, FABS**

**Catheryn M. Yashar, MD,  
FACRO, FABS**

## Ancillary Meetings

### Thursday, June 13, 2019

6:30 am Editorial Breakfast — *Escorial/Alhambra*

6:45 am Membership/Resident Committee — *Balmoral*

11:30 am International Committee — *Sandringham/Windsor*

### Friday, June 14, 2019

6:45 am Patient Safety Committee — *Balmoral*

### Saturday, June 15, 2019

6:45 am Physics Committee — *Brickell*

## Resident Travel Grant Recipients:

### Gabriela Alban, MD

Low-Dose 3-Fraction Adjuvant Vaginal Brachytherapy for Early-Stage Endometrial Cancer

### Kevin Martell, MD

Radiotherapy Practices in Post-Operative Endometrial Cancer: A Survey of the ABS Membership

### Yaser Hasan, MBChB

Toxicity and Quality of Life Results from a Randomized Phase II Trial of HDR Monotherapy for Low and Intermediate-Risk Prostate Cancer

### Noelia Sanmamed, MD

Long-Term Oncologic Outcomes of Low Dose Rate Brachytherapy Compared to Hypofractionated External Beam Radiotherapy for Intermediate Risk Prostate Cancer

### Zachary Horne, MD

National Patterns of Care and Under-Utilization of Radiation for Early-Stage Penile Cancers

### Birjoo Vaishnav, PhD

Predicting Deliverability for Nasobiliary High Dose Rate Brachytherapy Patients: A Retrospective Evaluation of Patient Catheter Curvature and Comparison with QA Results

### Corbin Jacobs, MD

Utilization of Brachytherapy for Early Stage Oral Cavity Cancers in the United State

### Christian Guthrie, PhD

Clinical Implementation of Automated Treatment Planning Including 3D Printable Applicators in Complex Skin Brachytherapy

### Jenna Kahn, MD

Accelerated Partial Breast Irradiation Brachytherapy as a Salvage Treatment Option for Ipsilateral Breast Tumor Recurrence

### Aleksandra Kucmarska-Haas, MD

Lumpectomy and Accelerated Partial Breast Irradiation as an Alternative to Mastectomy Following Prior Radiation Therapy

Sponsored by: **THERAGENICS CORPORATION\***



## ABS Annual Conference Mobile App

The **ABS Conference App** will elevate your conference experience exponentially. Connect with attendees and speakers, build your schedule, take notes in sessions, share your feedback, and more!

### Downloading the ABS Conference App is Easy!

The ABS Annual Conference Mobile App is ready to download on your iPhone, iPad, or Android! Go the right store. Access the App Store on iOS devices and the Play Store on Android. If you're using a Blackberry or Windows phone, skip these steps. You'll need to use the web version of the app found here:

<https://crowd.cc/abs19>

- Search for **CrowdCompass AttendeeHub**. Once you've found the app, tap either Get or Install. After installing, a new icon will appear on the home screen.
- Search the **AttendeeHub**. Once downloaded, open the AttendeeHub app and enter **2019 ABS Annual Conference** in the search bar.
- Open your event. Tap the name of your event, then tap Download to open it.

### Once installed, you'll have instant access to:

- The full event schedule
- Contact info for other attendees
- Social sharing on: **#ABSBRACHY19**
- Detailed info about speakers and sponsors
- Notifications of important updates



ABS CONFERENCE QR CODE



### Accreditation and Credit Statement:

This activity has been planned and implemented in accordance with the accreditation requirements and policies of the **Accreditation Council for Continuing Medical Education (ACCME)** through the joint providership of **PeerPoint Medical Education Institute** and the **American Brachytherapy Society**. The PeerPoint Medical Education Institute is accredited by the ACCME to provide continuing medical education for physicians.

PeerPoint Medical Education Institute designates the live format for this educational activity for a maximum of **21.25 AMA PRA Category 1 Credits™**. Physicians should only claim credit commensurate with the extent of their participation in the activity.

This activity has been approved for **46 MPCEC credits** by the **Commission on Accreditation of Medical Physicists Education programs (CAMPEP)** for **Medical Physics Continuing Education Credits (MPCEC)**.

Upon request, a record of attendance (certificate) will be provided on-site at the registration desk to other health care professionals for requesting credits in accordance with state nursing boards, specialty societies, or other professional associations.

### Conflict of Interest and Off-Label/Disclosure Statement:

Presenters at this meeting will disclose any conflict of interest or their intention to discuss off-label use, if applicable, in accordance with **ACCME Standards** and **FDA** requirements.

# THURSDAY

7:00 am – 5:30 pm	<b>Registration</b>	Satellite Registration
7:15 am – 7:00 pm	<b>Commercial Exhibits</b>	Mezzanine
7:15 am – 7:55 am	<b>Continental Breakfast</b>	Mezzanine
7:15 am – 7:45 am	<b>ePoster Walk with Vendors</b>	Mezzanine
7:55 am – 8:00 am	<b>Welcome</b>	Versailles
8:00 am – 9:00 am	<b>PROSTATE SESSION I:</b>	Versailles
	<b>SA-CME Prostate Cancer: Advances in Diagnostics and Patient Selection</b>	
Moderators:	<b>Neil B. Desai, MD, MHS</b>   University of Texas Southwestern <b>Patrick W. McLaughlin, MD</b>   University of Michigan/Providence Cancer Center	
Speakers:	<b>Genomic Classifiers</b> <b>Robert B. Den, MD, MS</b>   Thomas Jefferson University Hospital/Bodine Center for Cancer Treatment	
	<b>Targeted Biopsy/Fusion Biopsy</b> <b>Daniel Costa, MD</b>   UT Southwestern Medical Center	
	<b>Molecular Imaging</b> <b>Asheh Jani, MD, MSEE</b>   Emory University	
	<b>Urology</b> <b>Sanoj Punnen, MD</b>   University of Miami, Miller School of Medicine	
8:00 am – 9:00 am	<b>SCIENTIFIC SESSION:</b>	Trianon
	<b>GYN Proffered I</b>	
Moderators:	<b>Mohamed A. Elshaikh, MD</b>   Henry Ford Hospital <b>Neil K. Taunk, MD, MS</b>   University of Pennsylvania	
9:00 am – 10:00 am	<b>SCIENTIFIC SESSION:</b>	Trianon
	<b>Prostate Proffered Papers I</b>	
Moderators:	<b>Bradley R. Prestidge, MD, MS, FABS</b>   Bon Secours Oncology Specialists <b>Matthew M. Scala, MD</b>   Kaiser Permanente	
9:00 am – 10:00 am	<b>GYN SESSION I:</b>	Versailles
	<b>SA-CME The Hybrid Applicator—Why, How to Start and What to Expect</b>	
Moderator:	<b>Catheryn M. Yashar, MD, FACRO</b>   University of California, San Diego	
Speakers:	<b>Rationale for Use: What Does the Data Tell Us</b> <b>Matthew M. Harkenrider, MD</b>   Stritch School of Medicine, Loyola University Chicago	



---

**Getting Started with Hybrid Applicators**

**Scott M. Glaser, MD** | City of Hope Medical Center

---

**Practical Applications of the Venezia and Vienna Applicators**

**Catheryn M. Yashar, MD, FACRO** | University of California, San Diego

---

**Use of Combination Interstitial and Applicators in a High Volume Center**

**Daya N. Sharma, MD, DNB** | All India Institute of Medical Sciences

---

---

10:00 am – 10:30 am	<b>Refreshment Break</b>	Mezzanine
---------------------	--------------------------	-----------

---

10:00 am – 10:30 am	<b>ePoster Walk with Vendors</b>	Mezzanine
---------------------	----------------------------------	-----------

---

10:30 am – 11:30 am	<b>SKIN SESSION I:</b>	Versailles
---------------------	------------------------	------------

---

**Clinical and Technical Aspects of Cutaneous Brachytherapy**

Moderators: **Anna Likhacheva, MD, MPH** | Sutter Health, Sacramento, CA  
**Parag R. Sanghvi, MD, MSPH** | University of California, San Diego

---

Speakers: **Thomas C. Harris, PhD** | Brigham and Women's Hospital  
**Alexandra J. Stewart, DM, MRCP, FRCR** | St Luke's Cancer Centre,  
Royal Surrey County Hospital

---

10:30 am – 11:30 am	<b>BREAST SESSION I:</b>	Trianon
---------------------	--------------------------	---------

---

**SA-CME Partial Breast Irradiation 2019: Data, Guidelines, and Novel Approaches**

Moderator: **Chirag S. Shah, MD** | Cleveland Clinic

---

Speakers: **APBI Update**  
**Frank A. Vicini, MD, FACR, FABS** | 21st Century Oncology

---

**Novel PBI Techniques**

**Jaraszlow T. Hepel, MD** | Rhode Island Hospital/Brown University

---

**APBI Guidelines**

**Douglas W. Arthur, MD, FABS** | Virginia Commonwealth University

---

11:30 am – 12:45 pm	<b>Resident Luncheon (Residents Only)</b>	Balmoral
---------------------	---	----------

---

Sponsored by: **THERAGENICS CORPORATION**

---

12:45 pm – 1:45 pm	<b>MISCELLANEOUS SESSION I:</b>	Versailles
--------------------	---------------------------------	------------

---

**Building the Best Brachytherapy Practice**

Moderator: **Martin T. King, MD, PhD** | Brigham and Women's Hospital

---

Speakers: **Tiffany Phillips, PhD** | Cedars-Sinai Medical Center  
**Melinda Roach, RN, BSN** | Virginia Commonwealth University Health System  
**Marianne Weiler, BS** | Brigham and Women's Hospital/Dana Farber Cancer Institute  
**Lalaine B. Zaide, PA-C** | UCLA

---

12:45 pm – 1:45 pm **PHYSICS SESSION I:** Trianon

**SA-CME Critical Review of Radiobiology**

Moderators: **Ivan Buzurovic, PhD** | Dana Farber Brigham Women’s Cancer Center  
**Firas Mourtada, PhD** | Christiana Care Health System

Speakers: **Overview of Brachytherapy Radiobiology and Prostate Radiobiology**  
**Alvaro A. Martinez, MD, FACR, FABS** | MHP Radiation Oncology Institute

**Gynecological Radiobiology**

**Dorin A. Todor, PhD** | Virginia Commonwealth University Health System

**Applying Radiobiology to Brachytherapy Treatment Planning**

**Michael J. Zelefsky, MD** | Memorial Sloan-Kettering Cancer Center

1:45 pm – 3:00 pm **PHYSICS SESSION II:** Trianon

**A Critical Review of Technology—Improving Safety, Accuracy and Flexibility in Your Clinic**

Moderators: **Adam M. Cunha, PhD** | UCSF Comprehensive Cancer Center  
**Christian V. Guthier, PhD** | Brigham and Women’s Hospital

Speakers: **Electromagnetic Tracking Technology for Automated Catheter Digitization in HDR Prostate Brachytherapy**  
**Luc Beaulieu, PhD** | CHU De Québec – Ulaval

**Incident Learning Systems and Constructing Safety Barriers**

**Zoubir Ouhib, MS, DABR, FABS** | Lynn Cancer Institute

**The Use of MRI in Brachytherapy**

**Mahta M. McKee, MS** | Wake Forest University

**Multi-Criteria Optimization for Brachytherapy**

**Christopher L. Deufel, PhD** | Mayo Clinic

**Transitioning Technology to a Vendor Product: Vendor Roundtable**

1:45 pm – 3:00 pm **MISCELLANEOUS SESSION II:** Versailles

**Anesthesia and Pain Management in Brachytherapy**

Moderator: **Mitchell Kamrava, MD** | Cedars-Sinai Medical Center

Speakers: **Sephalie Patel, MD** | Moffitt Cancer Center  
**Nikhil G. Thaker, MD** | Arizona Oncology

3:00 pm – 4:00 pm **SCIENTIFIC SESSION:** Trianon

**Physics Proffered Papers**

Moderators: **Christopher L. Deufel, PhD** | Mayo Clinic  
**Sujatha Pai, MS, DABMP** | Landauer Medical Physics

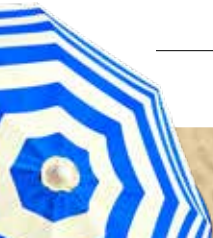



3:00 pm – 4:00 pm <b>SA-CME</b>	<b>Are You Up to Date with the NRC Requirements for Medical Event Reporting (10 CFR Part 35.3045)? Review and Test Cases</b>	Versailles
Moderator:	<b>Zoubir Ouhib, MS, DABR, FABS</b>   Lynn Cancer Institute	
Speakers:	<b>Maryann O. N. Ayoade, PhD</b>   US Nuclear Regulatory Commission <b>Zoubir Ouhib, MS, DABR, FABS</b>   Lynn Cancer Institute	
4:00 pm – 4:15 pm	<b>Refreshment Break</b>	Mezzanine
4:00 pm – 4:15 pm	<b>ePoster Walk with Vendors</b>	Mezzanine
4:15 pm – 5:15 pm	<b>SCIENTIFIC SESSION: Physics Snap Orals</b>	Trianon
Moderators:	<b>Wayne M. Butler, PhD, FABS</b>   Schiffler Cancer Center/Wheeling Hospital <b>Mark J. Rivard, PhD, FAAPM, FABS</b>   Rhode Island Hospital/Brown University	
5:15 pm – 6:30 pm	<b>SCIENTIFIC SESSION: Miscellaneous Proffered Papers</b>	Trianon
Moderators:	<b>Kunal Saigal, MD</b>   Florida Hospital Cancer Institute <b>Puja Venkat, MD</b>   UCLA	
4:15 pm – 6:15 pm	<b>WORKSHOPS</b>	
	<b>GYN WORKSHOP I: Applicator Selection and Placement</b>	Brickell
	A practical hand on session involving demonstration applicators from the major manufacturers, including new hybrid style sets. Stations will include anatomic mannequin models for practical demos of technique, and faculty from the meeting for small group discussion of their practices.	
	<b>Fundamental Skills</b> <b>Melissa M. Joyner, MD, MBA</b>   MD Anderson Cancer Center <b>Lisa Singer, MD, PhD</b>   Dana-Farber Cancer Institute	
	<b>US for Tandem Placement (VR)</b> <b>Shari Damast, MD</b>   Yale Cancer Center	
	<b>Use of Mannequins in Resident Education</b> <b>Emma C. Fields, MD</b>   Virginia Commonwealth University	
	<b>Applicator Selection and Placement</b> <b>Kristin A. Bradley, MD</b>   University of Wisconsin, Madison <b>Christine M. Fisher, MD, MPH</b>   University of Denver, Colorado <b>Lilie L. Lin, MD</b>   MD Anderson Cancer Center <b>Pranshu Mohindra, MD, MBBS</b>   University of Maryland School of Medicine <b>Neil K. Taunk, MD, MS</b>   University of Pennsylvania	



**PROSTATE WORKSHOP I:**Raphael/  
Michaelangelo**Intraoperative Workflow: Varian Users**

A practical hand on session that will follow an intraoperative LDR procedure. We will indicate similarities and differences between LDR and HDR procedures as needed as they share an overall similar workflow (both LDR and HDR software packages will be available for practice). This will incorporate the Varian treatment planning system.

Moderator: **Gil'ad N. Cohen, MS** | Memorial Sloan-Kettering Cancer Center

Speaker: **Anatomic Considerations in Prostate Brachytherapy**  
**Patrick W. McLaughlin, MD** | University of Michigan/Providence Cancer Center

Circulators: **Gil'ad N. Cohen, MS** | Memorial Sloan-Kettering Cancer Center  
**Michael Folkert, MD, PhD** | UT Southwestern  
**Robert F. Hobbs, PhD** | John Hopkins University  
**Brian Hrycushko, PhD** | UT Southwestern Medical Center  
**Patrick W. McLaughlin, MD** | University of Michigan/Providence Cancer Center  
**Zoubir Ouhib, MS, DABR, FABS** | Lynn Cancer Institute  
**Matthew M. Scala, MD** | Kaiser Permanente  
**Daniel Y. Song, MD** | Johns Hopkins University  
**Amandepp Taggar, MD, MS** | Sunnybrook Odette Cancer Centre

**SKIN WORKSHOP**

Escorial/Alhambra

This workshop will provide a hands-on experience to participants regarding modality selection and implementation in cutaneous brachytherapy. We will provide stations on treatment planning for HDR brachytherapy, applicators for electronic brachytherapy as well as on custom mold making, 3D printing and the use of ultrasound.

**Electronic Brachytherapy****Parag R. Sanghvi, MD, MSPH****Surface Mold HDR Ir-192 Brachytherapy****Philip M. Devlin, MD, FABS****HDR Ir-192 Brachytherapy****Alexandra J. Stewart, DM, MRCP****Interstitial Brachytherapy and Ultrasound****Anna Likhacheva, MD, MPH****Parag R. Sanghvi, MD, MSPH**6:15 pm – 7:15 pm **ePoster Walk with Vendors**

Mezzanine

6:15 pm – 7:15 pm **Welcome Reception**

Mezzanine



# FRIDAY

6:45 am – 5:45 pm	<b>Registration</b>	Satellite Registration
-------------------	---------------------	------------------------

6:45 am – 8:00 am	<b>SpaceOAR™ Hydrogel Breakfast Symposium</b>	Biscayne
-------------------	---	----------

Moderator: **Michael J. Zelefsky, MD**

Speakers: **Brian J. Davis, MD, PhD, FABS**  
**Rodney Ellis, MD**  
**Steven J. Frank, MD, FABS**  
**Alex Hsi, MD**

Sponsored by: 

7:15 am – 5:00 pm	<b>Commercial Exhibits</b>	Mezzanine
-------------------	----------------------------	-----------

7:15 am – 8:00 am	<b>Continental Breakfast</b>	Mezzanine
-------------------	------------------------------	-----------

7:15 am – 7:45 am	<b>ePoster Walk with Vendors</b>	Mezzanine
-------------------	----------------------------------	-----------

7:55 am – 8:00 am	<b>Welcome to Day 2</b>	Versailles
-------------------	-------------------------	------------

8:00 am – 9:00 am	<b>PROSTATE SESSION II:</b>	Versailles
-------------------	-----------------------------	------------

**SA-CME Focal Therapy for Prostate Cancer: An Emerging Modality**

Moderator: **Daniel Y. Song, MD** | Johns Hopkins University

Speakers: **Focal Therapy—Rationale, Current Methods and Experience**  
**Daniel Y. Song, MD** | Johns Hopkins University

**Experience and Viewpoints on Focal Brachytherapy: Panel Discussion**

**Alejandro Berlin, MD, MSc** | Princess Margaret Cancer Centre  
**Rod J. Ellis, MD** | University Hospitals Seidman Cancer Center  
**Brian J. Moran, MD, FABS** | Chicago Prostate Cancer Center

8:00 am – 9:00 am	<b>GYN SESSION II:</b>	Trianon
-------------------	------------------------	---------

**Art of GYN Brachytherapy—Challenging Cases, Custom Implants, Tricks and Techniques**

Moderator: **Beth A. Erickson, MD, FACR, FABS** | Medical College of Wisconsin

Speakers: **Free Hand Needles**  
**Christine M. Fisher, MD, MPH** | University of Denver, Colorado



---

**Inoperable Uterine Custom Implants**

**Junzo P. Chino, MD** | Duke University Medical Center

---

**Interstitial**

**Kristin A. Bradley, MD** | University of Wisconsin, Madison

---

**Practical Tips for US Guidance**

**Joe Hsu, MD** | UCSF Comprehensive Cancer Center

---

9:00 am – 10:00 am **SOCIOECONOMIC SESSION I:** Versailles

**The Shifting Landscape of Brachytherapy Reimbursement**

Moderator: **Nikhil G. Thaker, MD** | Arizona Oncology

Speakers: **Anne Hubbard** | ASTRO  
**Najeeb Mohideen, MD, FASTRO** | Northwest Community Hospital

---

9:00 am – 10:00 am **GYN PROFFERED PAPERS II** Trianon

Moderators: **David K. Gaffney, MD, PhD, FABS** | University of Utah  
**Diandra N. Ayala-Peacock, MD** | Vanderbilt University School of Medicine

---

10:00 am – 10:30 am **Refreshment Break** Mezzanine

10:00 am – 10:30 am **ePoster Walk with Vendors** Mezzanine

10:30 am – 10:45 am **Fellow Introduction** Versailles

**William S. Bice, PhD, FABS**  
**Mira Keyes, MD, FRCPC, FABS**  
**Gerard C. Morton, MD, FRCPC, FABS**  
**John E. Sylvester, MD, FABS**  
**Catheryn M. Yashar, MD, FACRO, FABS**

10:45 am – 11:00 am **Signing of WCB MOU**

**Bradley Pieters, MD**  
**Peter F. Orio, III, DO, MS**

---

11:00 am – 11:45 am **Presidential Address** Versailles

**Peter F. Orio, III, DO, MS**

---

11:45 am – 12:15pm **Keynote Address** Versailles

**Honorable Edward K. Newman** | Former All-Pro Offensive Guard, Miami Dolphins

---

12:15 pm – 1:30 pm **ABS Members Lunch and Annual Business Meeting** Biscayne

*(Event for ABS Members Only)*

Sponsored by: **THERAGENICS CORPORATION**

---



**Top Four Abstracts****Judith Stitt Awards**Sponsored by:  Elekta**Miscellaneous**

Surgically Targeted Radiation Therapy: Safety Profile of Collagen Tile Brachytherapy in 79 Recurrent, Previously Irradiated Intracranial Neoplasms on a Prospective Clinical Trial

**David G. Brachman, MD** | Barrow Neurological Institute, Phoenix, AZDiscussant: **Mitchell Kamrava, MD****Breast**

Immunomodulation of the Antitumor Response Induced by Alpha Radiation-Based Brachytherapy Results in the Elimination of Spontaneous Lung Metastases in a Triple Negative Breast Cancer Mice Model and in the Cure of Colon Cancer Bearing Mice

**Yona Keisari** | Tel Aviv University, Tel Aviv, IsraelDiscussant: **Chirag Shah, MD****GYN**

Real-Time Verification of Cylinder-Based GYN HDR Treatments Using a Fiber-Optic Detector

**Xinyi Shen, MS** | Duke University, Durham, NCDiscussant: **Timothy N. Showalter, MD, MPH****Prostate**

Long-Term Results of NRG Oncology/RTOG 0321 A Phase II Trial of Combined High Dose Rate Brachytherapy and External Beam Radiotherapy for Adenocarcinoma of the Prostate

**I-Chow Hsu, MD** | UCSF Comprehensive Cancer Center, San Francisco, CADiscussant: **Michael R. Folkert, MD, PhD****2019 Recipient: Gregory S. Merrick, MD, FABS**

Sponsored by:



3:00 pm – 4:00 pm	<b>Preparation and Polish: Techniques for Brachytherapy Education and Training</b>	Trianon
Moderators:	<b>Emma C. Fields, MD</b>   Virginia Commonwealth University Cancer Center <b>Steven J. Frank, MD</b>   UT MD Anderson Cancer Center	
Speakers:	<b>GYN</b> <b>Shari Damast, MD</b>   Yale School of Medicine <b>Lisa Singer, MD, PhD</b>   Dana-Farber Cancer Institute <b>Neil K. Taunk, MD, MS</b>   University of Pennsylvania	
	<b>Prostate</b> <b>Michael Folkert, MD, PhD</b>   UT Southwestern <b>Chad Tang, MD</b>   MD Anderson Cancer Center	
3:00 pm – 4:00 pm	<b>PHYSICS SESSION III:</b>	Versailles
<b>SA-CME</b>	<b>How We Do It—A Spotlight on Brachytherapy Techniques</b>	
Moderators:	<b>Shirin A. Enger, PhD</b>   McGill University <b>Daniel J. Scanderbeg, PhD</b>   University of California, San Diego	
Speakers:	<b>Making the Transition from CT to MRI or Ultrasound for Prostate HDR Brachytherapy</b> <b>Ananth Ravi, PhD, MCCPM</b>   Sunnybrook Odette Cancer Centre	
	<b>Optimizing the MRI Workflow in Your Clinic</b> <b>Dawn Owen, MD</b>   University of Michigan Medical Center <b>Joann Prisciandaro, PhD</b>   University of Michigan Medical Center	
	<b>Software for the Automation of Treatment Planning and Plan Checking</b> <b>Gil'ad N. Cohen, MS</b>   Memorial Sloan-Kettering Cancer Center	
3:00 pm – 4:00 pm	<b>Integrating Social Media into Your Practice</b>	Sandringham/ Windsor
Moderator:	<b>Miriam Knoll, MD</b>   Hackensack UMC/Mountainside	
Speakers:	<b>Nadine Housri, MD</b>   Yale University School of Medicine/MedNet <b>Chirag S. Shah, MD</b>   Cleveland Clinic	
4:00 pm – 4:15 pm	<b>Refreshment Break</b>	Mezzanine
4:15 pm – 5:15 pm	<b>Breast Session II:</b>	Versailles
	<b>Partial Breast Irradiation: Targets and Techniques</b>	
Moderator:	<b>Bethany Anderson, MD</b>   University of Wisconsin	
Speakers:	<b>Interstitial/Applicator Brachy</b> <b>Bethany Anderson, MD</b>   University of Wisconsin	
	<b>IMRT/3DCRT</b> <b>Kathleen C. Horst, MD</b>   Stanford University Medical Center	

---

**IORT**

**Parul N. Barry, MD** | Rush University Medical Center

---

**NIBB**

**Jaroslav T. Hepel, MD** | Rhode Island Hospital/Brown University

---

5:15 pm – 6:30 pm

**SCIENTIFIC SESSION:**

Trianon

**Miscellaneous Snap Orals**

Moderators: **Martin T. King, MD, PhD** | Brigham and Women's Hospital  
**Amandepp Taggar, MD, MS** | Sunnybrook Odette Cancer Centre

---

4:15 pm – 6:15pm

**WORKSHOPS****GYN WORKSHOP II: Contouring Treatment Planning**

Brickell

A contouring session for gynecologic malignancies on MRI and CT, with attention to both OAR and target definitions. Participants will have the opportunity to contour in real time in treatment planning systems. Physicists will then demonstrate the planning processes for the same cases.

---

**Kevin V. Albuquerque, MD** | UT Southwestern  
**Junzo Chino, MD** | Duke University Medical Center  
**Xun Jia, PhD** | UT Southwestern  
**Sheridan Melstner, MD** | Duke University Medical Center

---

**PROSTATE WORKSHOP II:**

Michaelangelo/  
Raphael

**Intraoperative Workflow: Elekta Users**

A practical hand on session that will follow an intraoperative LDR procedure. We will indicate similarities and differences between LDR and HDR procedures as needed as they share an overall similar workflow (*both LDR and HDR software packages will be available for practice*). This will incorporate the Elekta treatment planning system.

---

Moderator: **Gil'ad N. Cohen, MS** | Memorial Sloan-Kettering Cancer Center

---

Speaker: **Anatomic Considerations in Prostate Brachytherapy**

---

**Patrick W. McLaughlin, MD** | University of Michigan/Providence Cancer Center

---

Circulators: **Gil'ad N. Cohen, MS** | Memorial Sloan-Kettering Cancer Center  
**Michael Folkert, MD, PhD** | UT Southwestern  
**Robert F. Hobbs, PhD** | Johns Hopkins University  
**Brian Hrycushko, PhD** | UT Southwestern Medical Center  
**Patrick W. McLaughlin, MD** | University of Michigan/Providence Cancer Center  
**Zoubir Ouhib, MS, DABR, FABS** | Lynn Cancer Institute  
**Matthew M. Scala, MD** | Kaiser Permanente  
**Daniel Y. Song, MD** | Johns Hopkins University  
**Amandepp Taggar, MD, MS** | Sunnybrook Odette Cancer Centre

---

6:15 pm – 7:15 pm

**President's Reception**

Lower Pool Deck

---



# SATURDAY

6:45 am – 1:00 pm	<b>Registration</b>	Satellite Registration
-------------------	---------------------	------------------------

6:45 am – 8:00 am	<b>Breast Symposium Breakfast:</b>	Sandringham/ Windsor
-------------------	------------------------------------	-------------------------

## Breast Radiotherapy and Reconstruction: Challenging Cases

Moderator: **Jessica Schuster, MD** | University of Wisconsin

Speakers: **IORT**

**Chirag S. Shah, MD** | MD Cleveland Clinic

**Biozorb**

**Robert R. Kuske, Jr., MD, FABS** | Arizona Center for Cancer Care

Sponsored by:



7:15 am – 7:45 am	<b>ePoster Walk with Vendors</b>	Mezzanine
-------------------	----------------------------------	-----------

7:15 am – 8:00 am	<b>Continental Breakfast</b>	Mezzanine
-------------------	------------------------------	-----------

7:15 am – 11:00 am	<b>Commercial Exhibits</b>	Mezzanine
--------------------	----------------------------	-----------

7:55 am – 8:00 am	<b>Daily Recap</b>	Versailles
-------------------	--------------------	------------

8:00 am – 9:00 am	<b>MISCELLANEOUS SESSION III:</b>	Versailles
-------------------	-----------------------------------	------------

### SA-CME Updates on Target Dose and Organ at Risk Constraints for Prostate, Gynecologic and Skin Cancers

Moderator: **Omar M. Ragab, MD** | University of Southern California

Speakers: **Skin**

**Christopher A. Barker, MD** | Memorial Sloan Kettering Cancer Center

**GYN**

**Gita Suneja, MD, MSHP** | Duke University

**Prostate**

**Hans Chung, MD, FRCPC** | Sunnybrook Odette Cancer Center

8:00 am – 9:00 am	<b>SOCIOECONOMIC SESSION:</b>	Trianon
	<b>SA-CME Understanding Brachytherapy Billing and Coding and 2019 Coding Updates</b>	
Moderator:	<b>Peter F. Orio, III, DO, MS</b>   Dana-Farber Brigham and Women's Cancer Center	
Speakers:	<b>Peter F. Orio, III, DO, MS</b>   Dana-Farber Brigham and Women's Cancer Center <b>Nikhil G. Thaker, MD</b>   Arizona Oncology <b>Catheryn M. Yashar, MD, FACRO</b>   University of California, San Diego	
8:00 am – 9:00 am	<b>SCIENTIFIC SESSION:</b>	Sandringham/ Windsor
	<b>Breast Snap Orals</b>	
Moderators:	<b>Peter Y. Chen, MD, FACR</b>   Beaumont Health System <b>Noah Kalman, MD</b>   Miami Cancer Institute at Baptist Health South Florida	
9:00 am – 10:00 am	<b>PROSTATE SESSION III:</b>	Versailles
	<b>Salvage Therapies in Prostate Cancer: Best Practices and Case Discussions</b>	
Moderator:	<b>Marissa A. Kollmeier, MD</b>   Memorial Sloan-Kettering Cancer Center	
Speakers:	<b>Salvage HDR</b> <b>Hans Chung, MD, FRCPC</b>   Sunnybrook Odette Cancer Center	
	<b>Salvage Therapy and Interventional Technologies</b> <b>Julio M. Pow-Sang, MD</b>   Moffitt Cancer Center	
9:00 am – 10:00 am	<b>SCIENTIFIC SESSION:</b>	Trianon
	<b>Breast Proffered Papers</b>	
Moderators:	<b>Alfredo I. Urdaneto, MD</b>   Virginia Commonwealth University <b>Jessica Wobb, MD</b>   Kettering Health Network	
10:00 am – 10:30 am	<b>Refreshment Break</b>	Mezzanine
10:00 am – 10:30 am	<b>ePoster Walk with Vendors</b>	Mezzanine
10:30 am – 11:30 am	<b>SCIENTIFIC SESSION:</b>	Trianon
	<b>Prostate Proffered Papers II</b>	
Moderators:	<b>Matthew T. Studenski, PhD</b>   University of Miami <b>Chad Tang, MD</b>   MD Anderson Cancer Center	



10:30 am – 11:30 am **GYN SESSION III:** Versailles

**SA-CME Controversies in Uterine Cancer**

Moderators: **Pranshu Mohindra, MD, MBBS** | University of Maryland School of Medicine

Speakers: **Bradley Corr, MD** | University of Colorado  
**Emma C. Fields, MD** | Virginia Commonwealth University Cancer Center  
**Ann Klopp, MD, PhD** | MD Anderson Cancer Center

11:30 am – 12:30 am **SCIENTIFIC SESSION:** Versailles

**Prostate Snap Orals**

Moderators: **Lara Hathout, MD, MD, FRCPC** | Rutgers Cancer Institute of New Jersey  
**Peter J. Rossi, MD** | Calaway Young Cancer Center at Valley View Hospital

11:30 am – 12:30 pm **SCIENTIFIC SESSION:** Trianon

**GYN Snap Orals**

Moderators: **Jyoti Mayadev, MD** | University of California San Diego  
**Daphna Y. Spiegel, MD** | Beth Israel Deaconess Medical Center

12:30 pm **2019 Annual Meeting Adjourns**





# Thank You to Our Sponsors!

## Premier

---



## Platinum

---



## Gold

---



## Silver

---



## Bronze

---



# Hotel Floor Plan Meeting Rooms

## LEVEL 2 | MEZZANINE

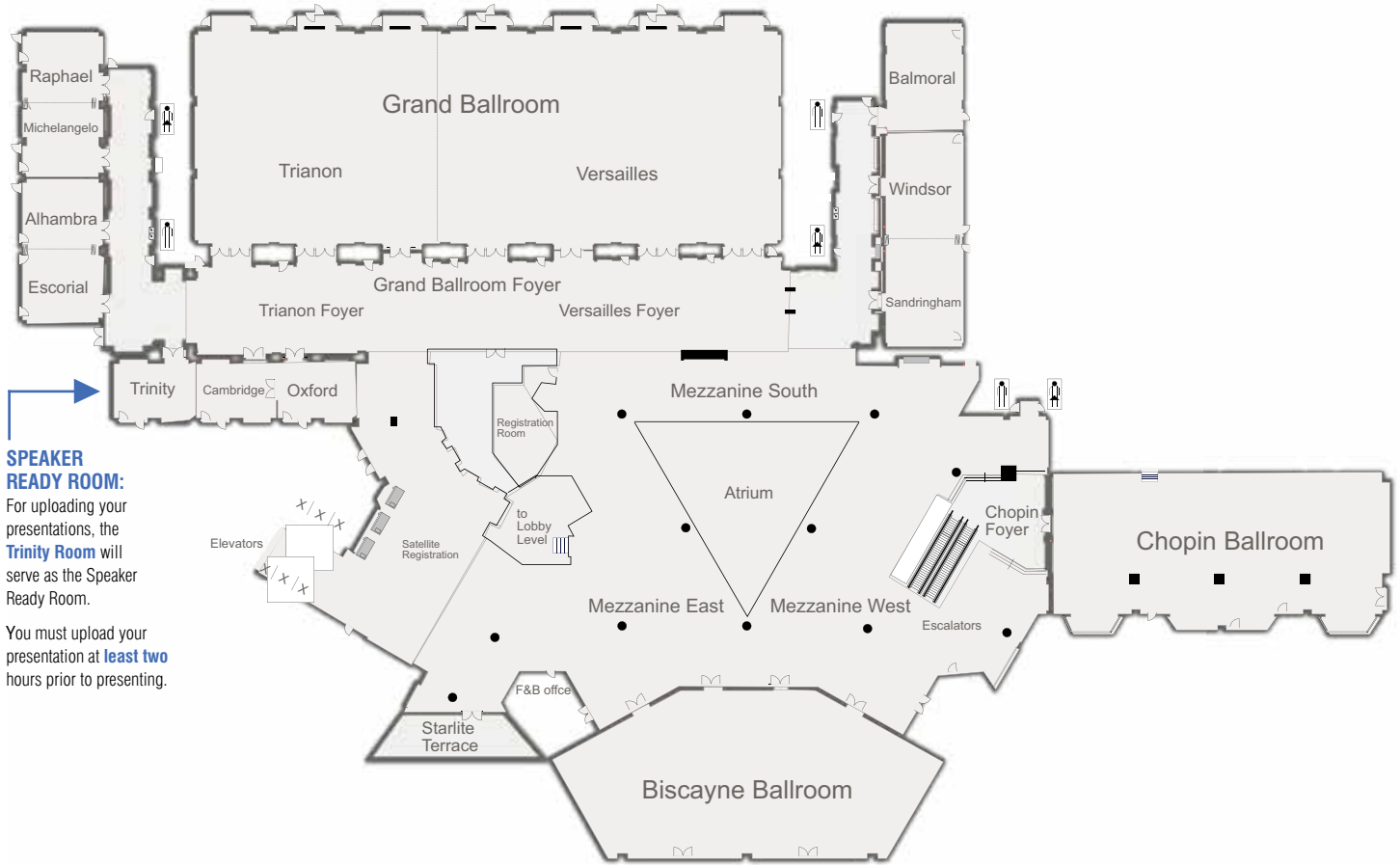

**SPEAKER READY ROOM:**  
For uploading your presentations, the **Trinity Room** will serve as the Speaker Ready Room.

You must upload your presentation at **least two** hours prior to presenting.

## LOBBY LEVEL



# Exhibit Hall Floor Plan

BOOTH #	EXHIBITOR
1	BK Medical
2	MIM Software, Inc.
3	3D Biopsy/SIM
4	Cianna Medical
5	Varian Medical Systems
6	Mobius
7	Best Medical
8	Pyrexer Medical
9	Augmenix/Boston Scientific
10 & 11	QFix
12	IsoAid
13	Concure Oncology
14	IsoRay, Inc.
15	Hitachi
16 & 17	Samsung Neurological
18 & 19	Theragenics Corporation
20	C4 Imaging
21	Civa Tech
22	Orfit Industries
23	MultiView
25	Electa

TABLETOP	EXHIBITOR
A	AccuBoost
B	Siemens
C	CIVCO Radiotherapy
E	Vitramed
F	GT Medical
G	CIVCO Medical Solutions
H	Myriad
M	Sensus Healthcare
N	Xoft, a Subsidiary of iCAD
O	Alpha Tau
P	Associates in Medical Physics
Q	Angiodynamics
R	Medi Lazer

 MONITOR LOCATIONS

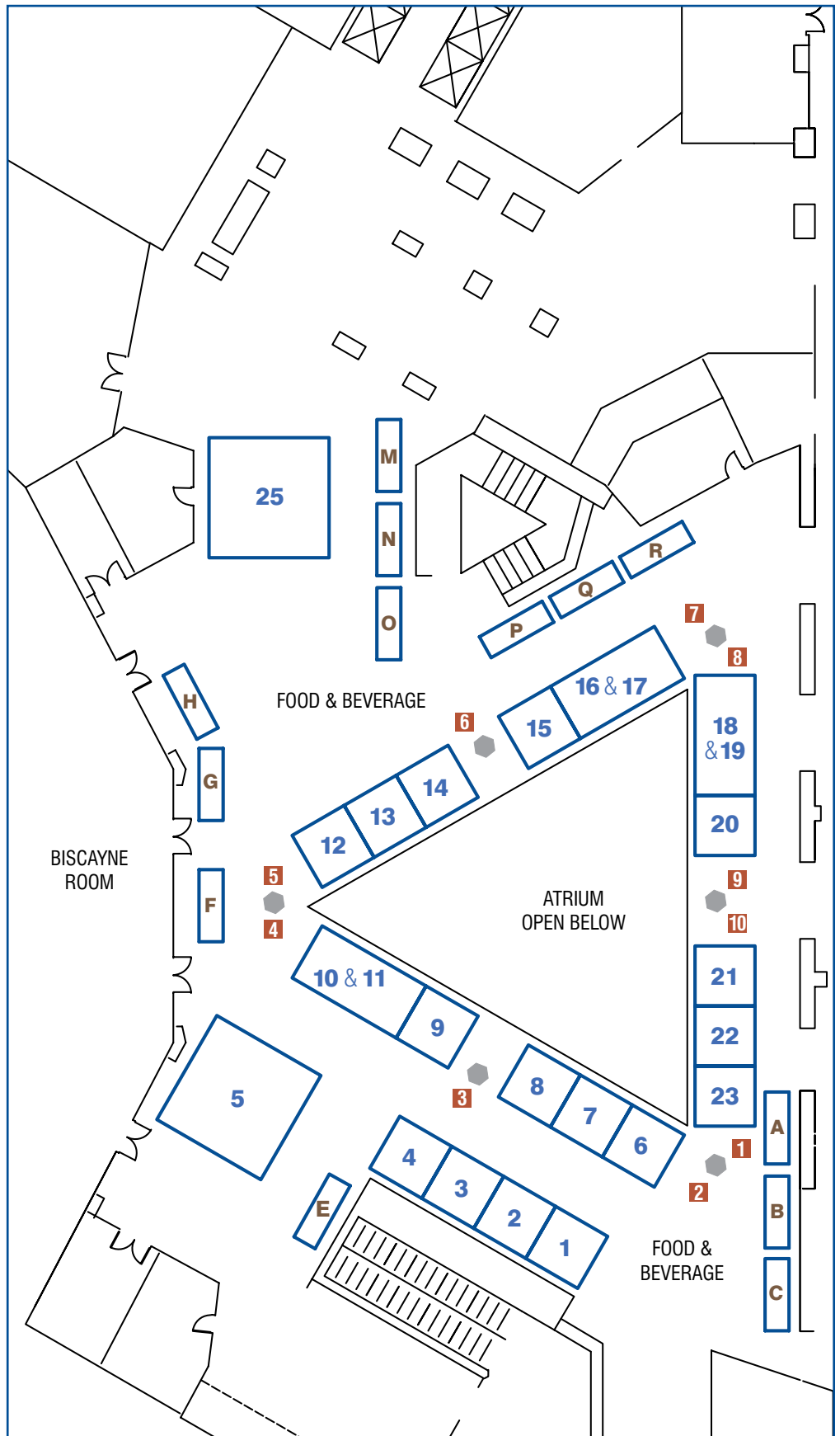





# FUTURE MEETINGS

## American Brachytherapy Society

11130 Sunrise Valley Drive | Suite 350  
Reston, Virginia 20191

P 703.234.4078 | F 703.435.4390  
[www.americanbrachytherapy.org](http://www.americanbrachytherapy.org)

# BRACHYSUMMIT

# 2020



**FEBRUARY 14-16, 2020**

Big Sky Resort | Big Sky, Montana

**REGISTRATION COMING SOON!**



## 2019 PROSTATE WORKSHOP



**NOVEMBER 1-2**

Hyatt Regency Denver  
at Colorado Convention Center  
Denver, Colorado